

# REED 5120HP CONCRETE PUMP

## SECTION 10:

### PARTS INFORMATION, WARRANTY & SERVICE

---

---

#### PAGE

1	AXLE & FRAME ASSEMBLY
2	CONTROL PANEL
3	POWER TRAIN ASSEMBLY
4	HYDRAULIC VALVES
5	CYLINDER END CAPS
6	HYDRAULIC PUMP / Sauer-Sundstrand Technical Data
7	FLUSHBOX AREA
8	CONCRETE AND HYDRAULIC CYLINDERS
9	SWING TUBE ASSEMBLY, OUTLET, HOPPER
10	HYDRAULIC CYLINDERS / SWING TUBE
11	REAR HYDRAULIC TANK
12	AUGER

## PARTS INFORMATION, WARRANTY AND SERVICE

### General

Reed is continually improving its product range, therefore, specifications are subject to change without prior notice.

### Parts

The parts section contains a break-down by part number of all the replaceable parts used in a particular concrete pump. The drawings shown in the parts section are intended to aid understanding of the construction of the product and to assist in ordering parts. They are also helpful in determining the sequence of assembling various parts when making adjustments and repairs.

### Placing orders for parts

The satisfactory ordering and receiving of parts is greatly dependent upon specific and correct information supplied by the owner. Many unnecessary errors and delays may be eliminated by conforming to the following instructions:

- Your parts order should state:
1. The exact model and serial number of the machine. See name plate on frame assembly.
  2. Your company order#
  3. Part number, description, and quantity required.
  4. Write the order clearly, using a typewriter, if possible.
  5. State your company name, address, and zip code.
  6. Specify shipping instructions.

FRAME AND AXLE ASSEMBLY

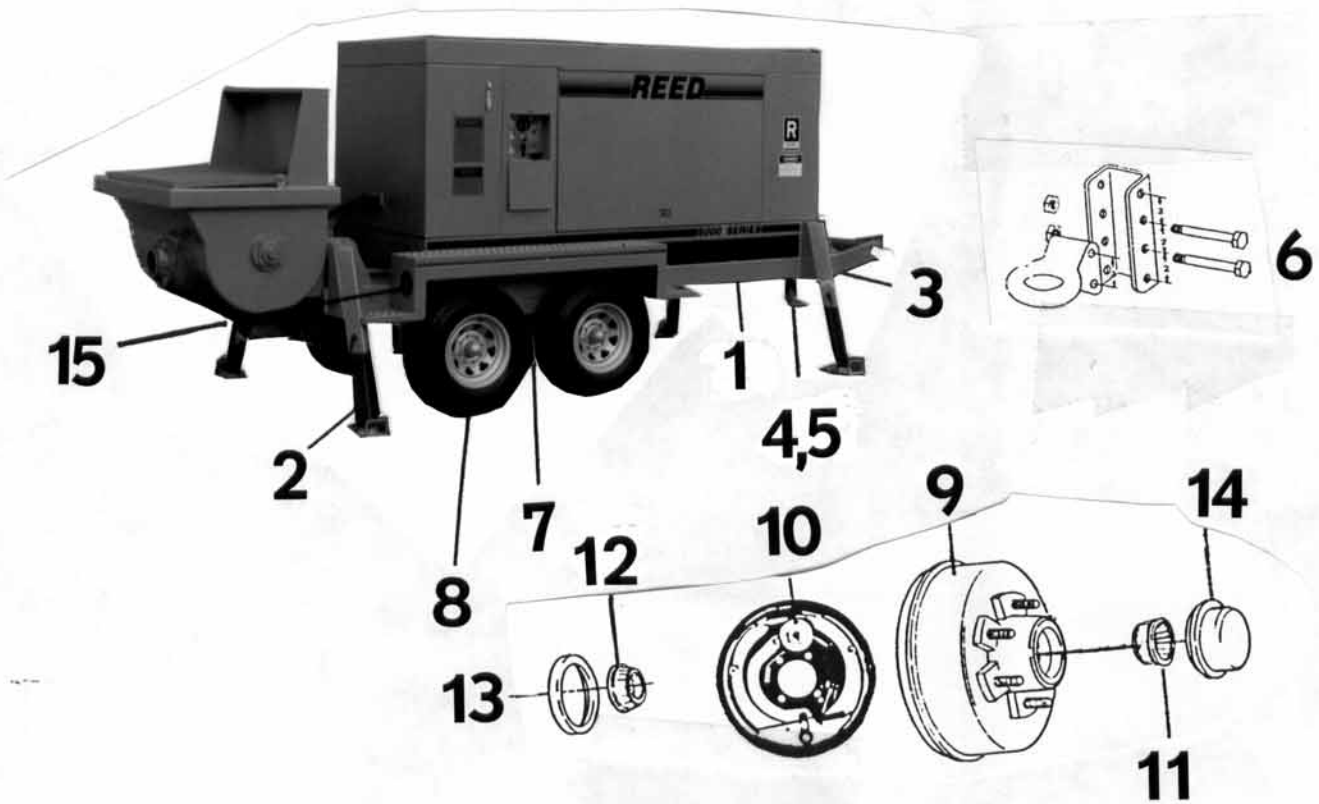

<u>ITEM</u>	<u>DESCRIPTION</u>	<u>PART#</u>	<u>QTY</u>
1	FRAME WELDMENT	75153	1
2	OUTRIGGER TUBE (INNER)	75250	4
3	OUTRIGGER TUBE (OUTER)	75251	4
4	OUTRIGGER WELDMENT (JACK DROP LEG)	75252	1
5	JACK PAD	75253	1
6	LUNETTE EYE 3"	71051	1
7	TANDEM AXLES	75152	2
8	WHEEL AND TIRE	71066	4
9	BRAKE DRUM	71097	4
10	ELECTRIC BRAKE	71056	4
11	OUTER BEARING	71098	4
12	INNER BEARING	71094	4
13	GREASE SEAL	71095	4
14	DUST CUP	71199	4
15	TAIL LIGHT	72984	2

## CONTROL PANEL

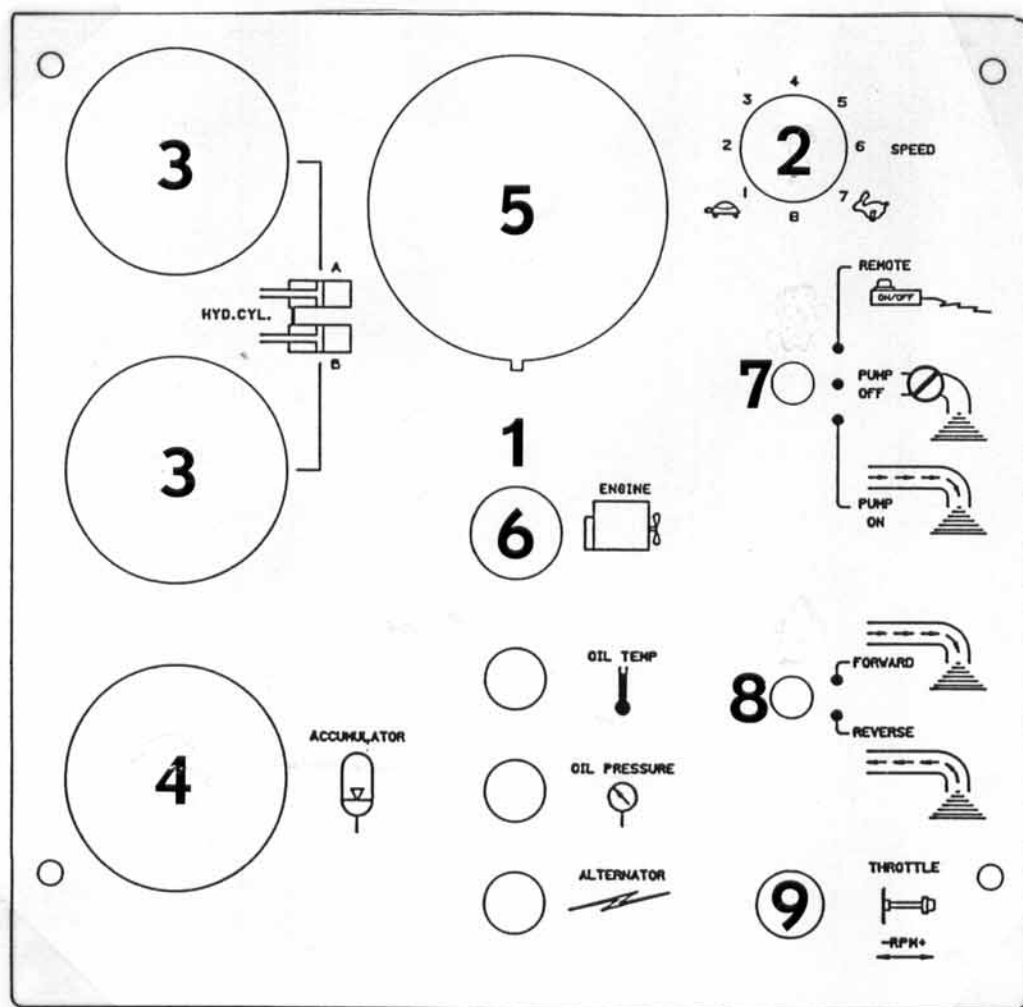

<u>ITEM</u>	<u>DESCRIPTION</u>	<u>PART#</u>
1	CONTROL PANEL PLATE	75231
2	POTENTIOMETER	72966
3	0-5000 P.S.I. GAUGE	74562
4	0-3000 P.S.I. GAUGE	70366
5	ACT/HOUR/TACH GAUGE (0-4000)	71119
6	IGNITION SWITCH	72946
7	SWITCH	72963
8	SWITCH	72964
9	THROTTLE CABLE ASSEMBLY	72810

POWER TRAIN ASSEMBLY

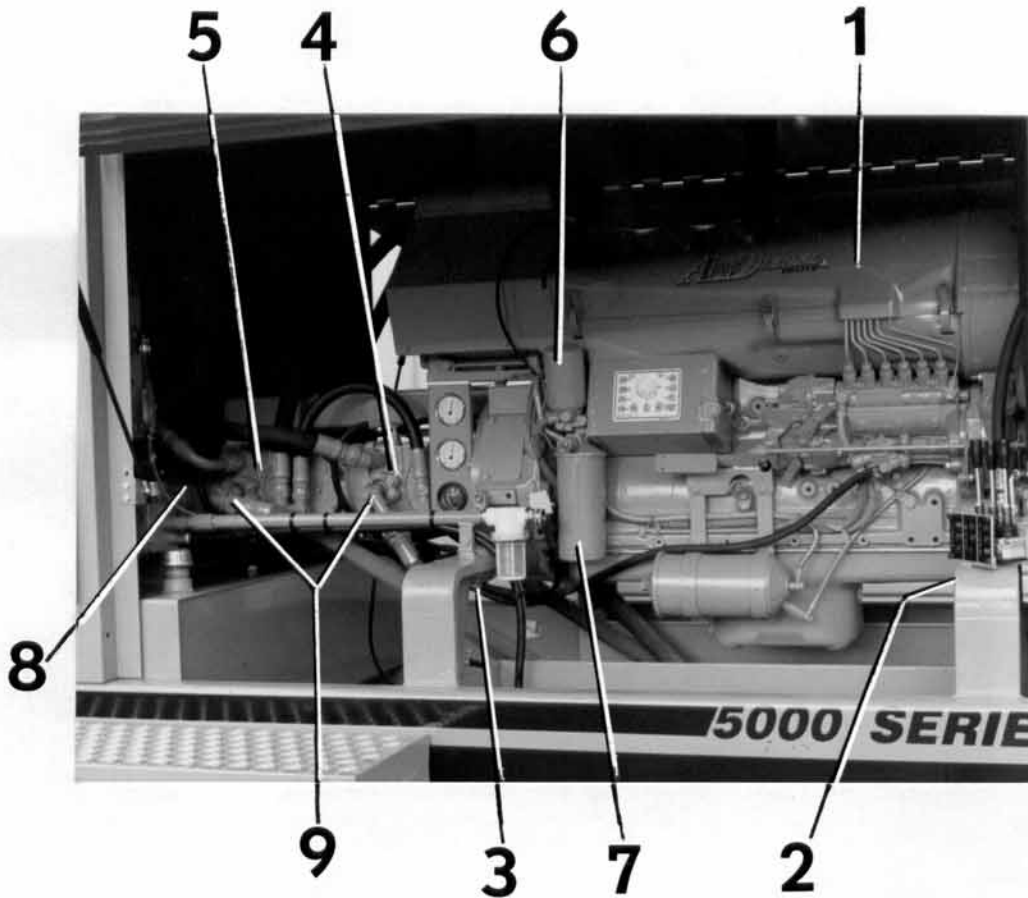

<u>ITEM</u>	<u>DESCRIPTION</u>	<u>PART #</u>
1	ENGINE	75121
2	ENGINE MOUNT (FRONT)	71125
3	ENGINE MOUNT (REAR)	71126
4	FRONT HYD. PUMP (SUNDSTRAND)	75122
5	REAR HYD. PUMP (SUNDSTRAND)	75123
6	FUEL FILTER	74501
7	OIL FILTER	75343
8	AUXILIARY PUMP	75124
9	FLANGE KIT	74609

HYDRAULIC VALVES

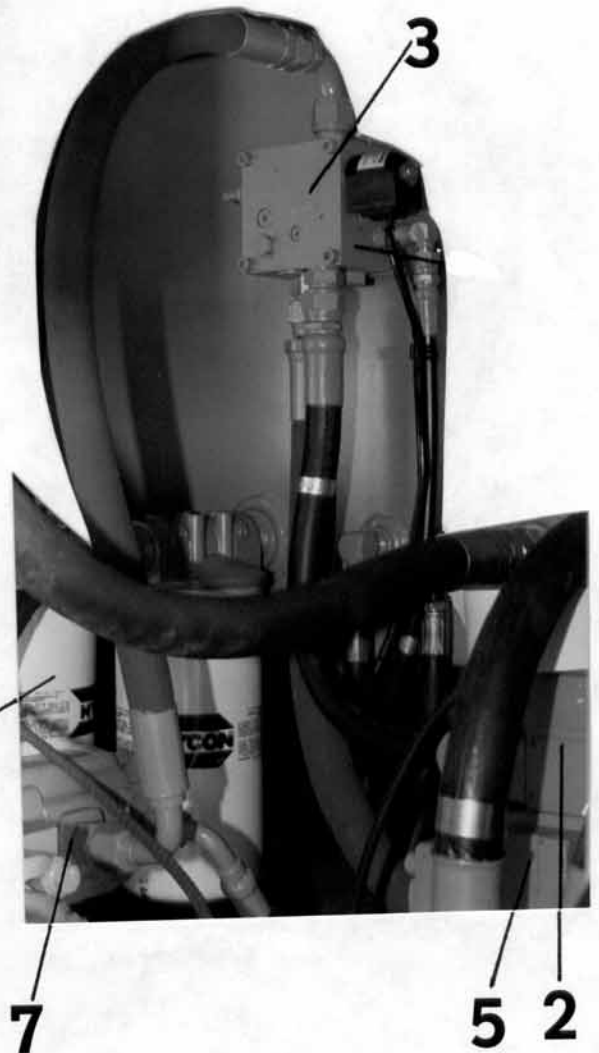
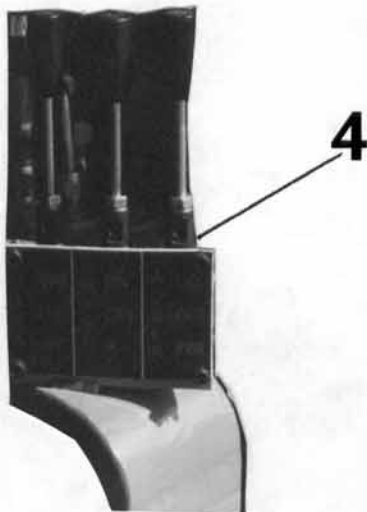
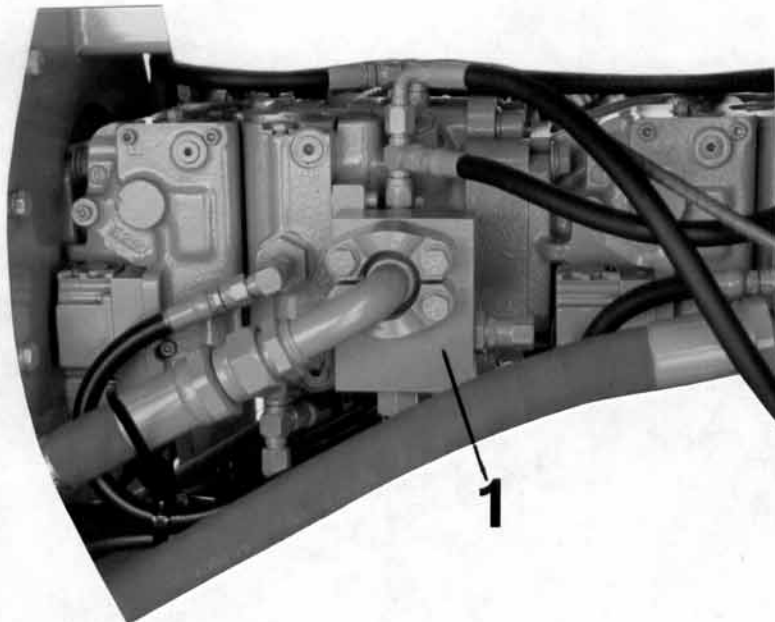

<u>ITEM</u>	<u>DESCRIPTION</u>	<u>PART #</u>
1	HOT OIL SHUTTLE	72980
2	A. A. VALVE	75161
3	UNLOADER BLOCK	72803
4	VALVOIL VALVE	74471
5	D08 SUBPLATE	75124
6	HYCON FILTER	72979
7	GEAR PUMP (AUXILIARY)	75124

CYLINDER END CAPS

FRONT ENCLOSURE

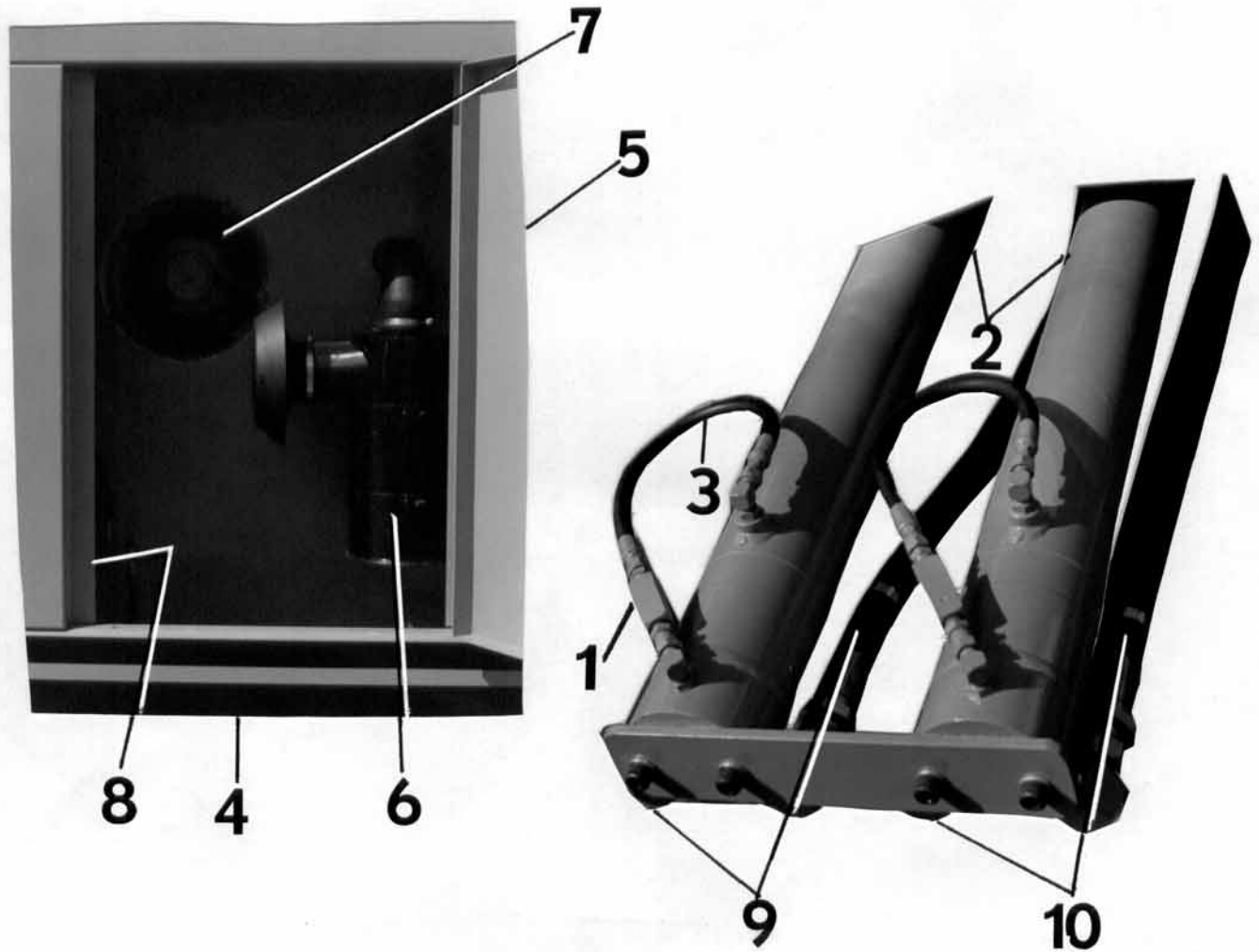

<u>ITEM</u>	<u>DESCRIPTION</u>	<u>PART #</u>
1	CHECK VALVE	74580
2	HYDRAULIC CYLINDER ASSEMBLY	75128
3	HOSE (LOOP)	74615
4	FRAME ASSEMBLY	75153
5	FRONT DOOR PANEL	75229
6	AIR FILTER ASSY.	N.P.N.
7	BRUSH RING	75273
8	JACK CYLINDER (NOT SHOWN)	75254
9	HOSES (FRONT PUMP:L-R)	75309
10	HOSES (REAR PUMP:L-R)	75308

HYDRAULIC TANK ASSEMBLY (RESERVOIR)

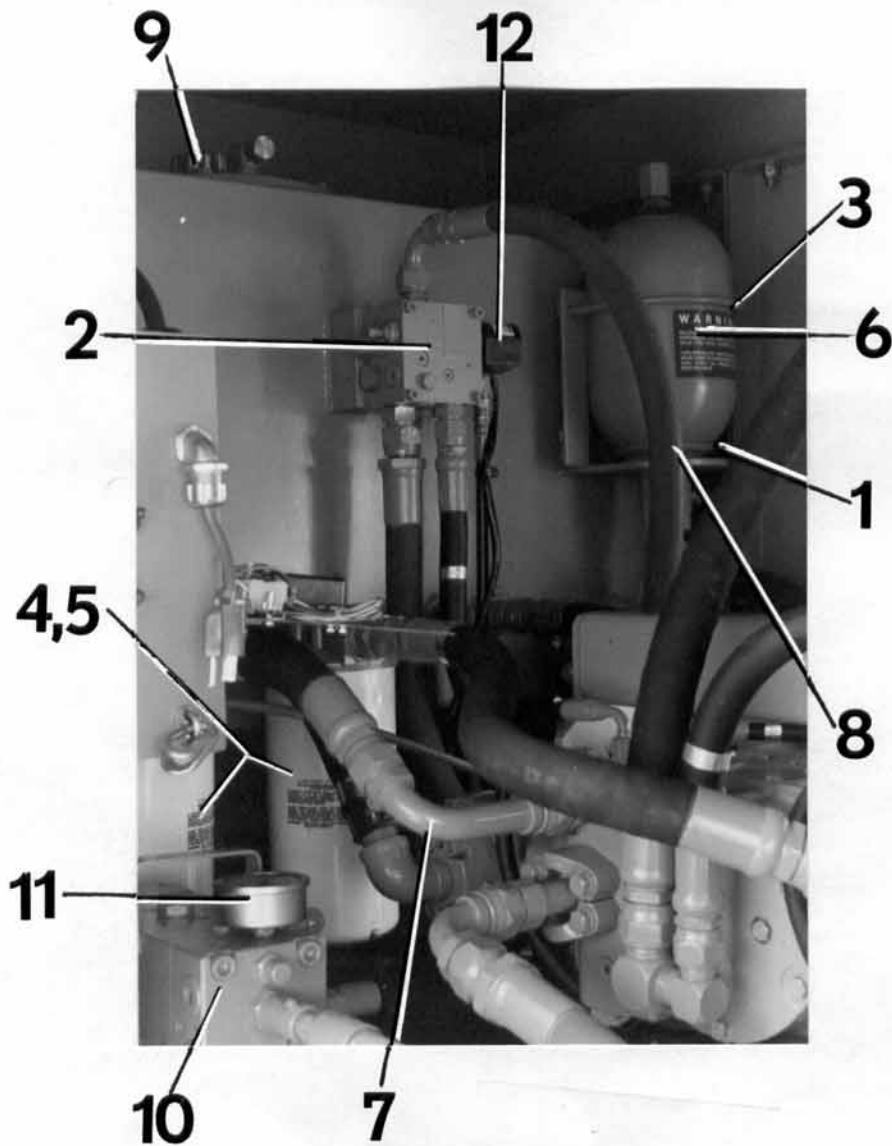

<u>ITEM</u>	<u>DESCRIPTION</u>	<u>PART #</u>
1	RUBBER WASHER	12075
2	UNLOADER ASSEMBLY	72803
3	U - BOLT	70066
4	HYDRAULIC FILTER ASSY.	72979
5	ELEMENT	72943
6	ACCUMULATOR	74515
7	TUBE ELBOW	74687
8	BUSHING	74676
9	BREATHER CAP	74508
10	WATER WASHING PUMP	70990
11	Pressure Gauge	N.P.N
-	COUPLED SUCTION HOSE	40596
12	SOLENOID	N.P.N



FLUSHBOX AREA

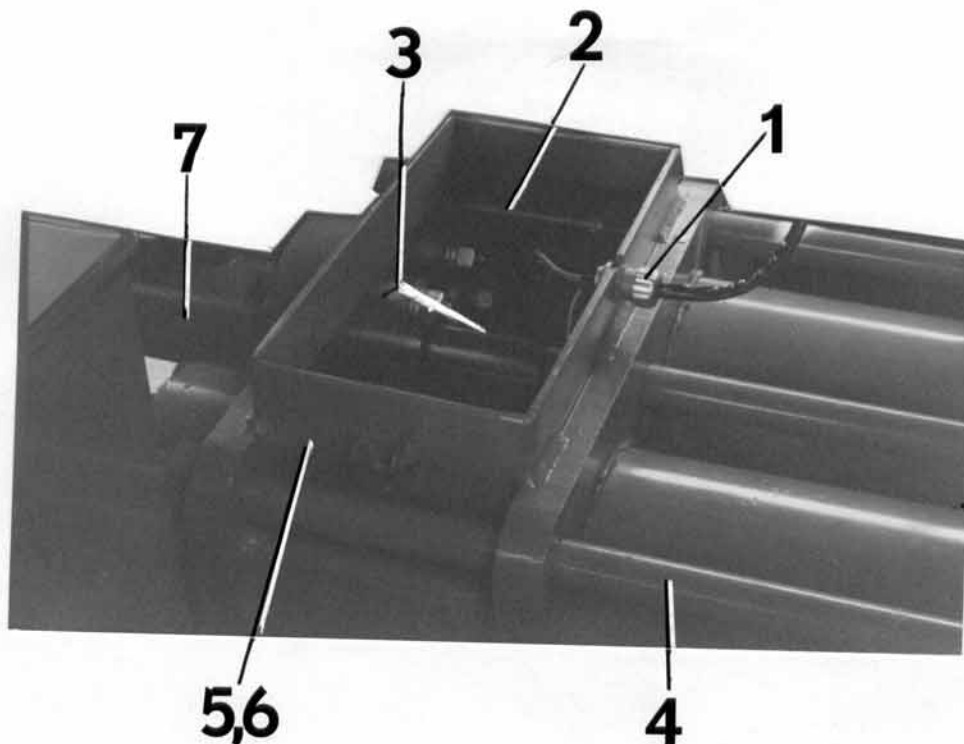

<u>ITEM</u>	<u>DESCRIPTION</u>	<u>PART #</u>
1	PROXIMITY SENSOR	72961
2	MOUNTING ANGLE	75157
3	PROXIMITY MOUNTING PLATE	75158
4	TIE ROD	75200
5	FLUSHBOX	75212
6	FLUSHBOX LID	75211
7	HYDRAULIC CYLINDERS ASSY.	75127

CONCRETE AND HYDRAULIC CYLINDERS

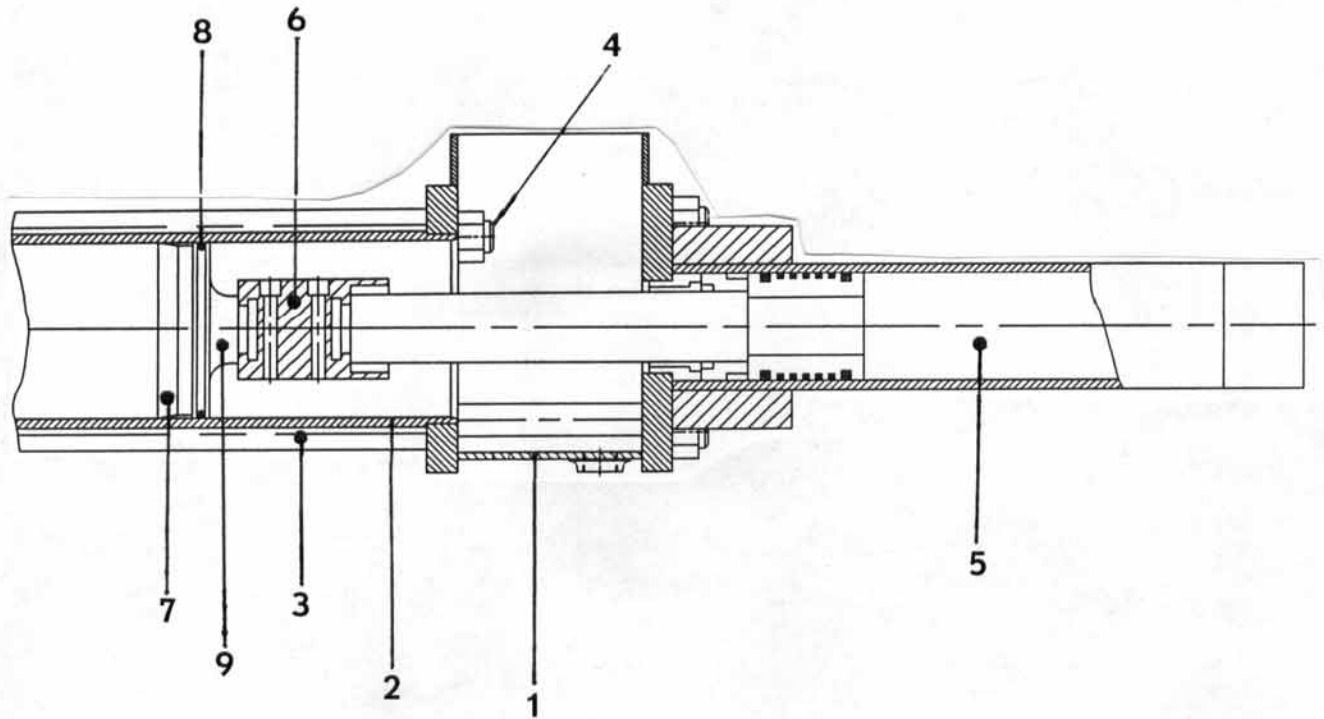

<u>ITEM</u>	<u>DESCRIPTION</u>	<u>PART#</u>	<u>QTY/MACH</u>
1	Flush Box	75133	1
2	Concrete Cylinder 78" x 7"	75127	2
3	Tie Rod Concrete Cylinder (Long)	75200	1
4	Tie Rod Concrete Cylinder (Short)	75201	5
5	Hydraulic Cylinder Assembly	75128	2
6	Coupling Assembly Matched Pair	75347	2
7	Piston Cups	75205	2
8	O-Ring	75199	2
9	Concrete Piston Adaptor	70503	2

SWINGTUBE ASS'Y OUTLET HOPPER 5000 SERIES

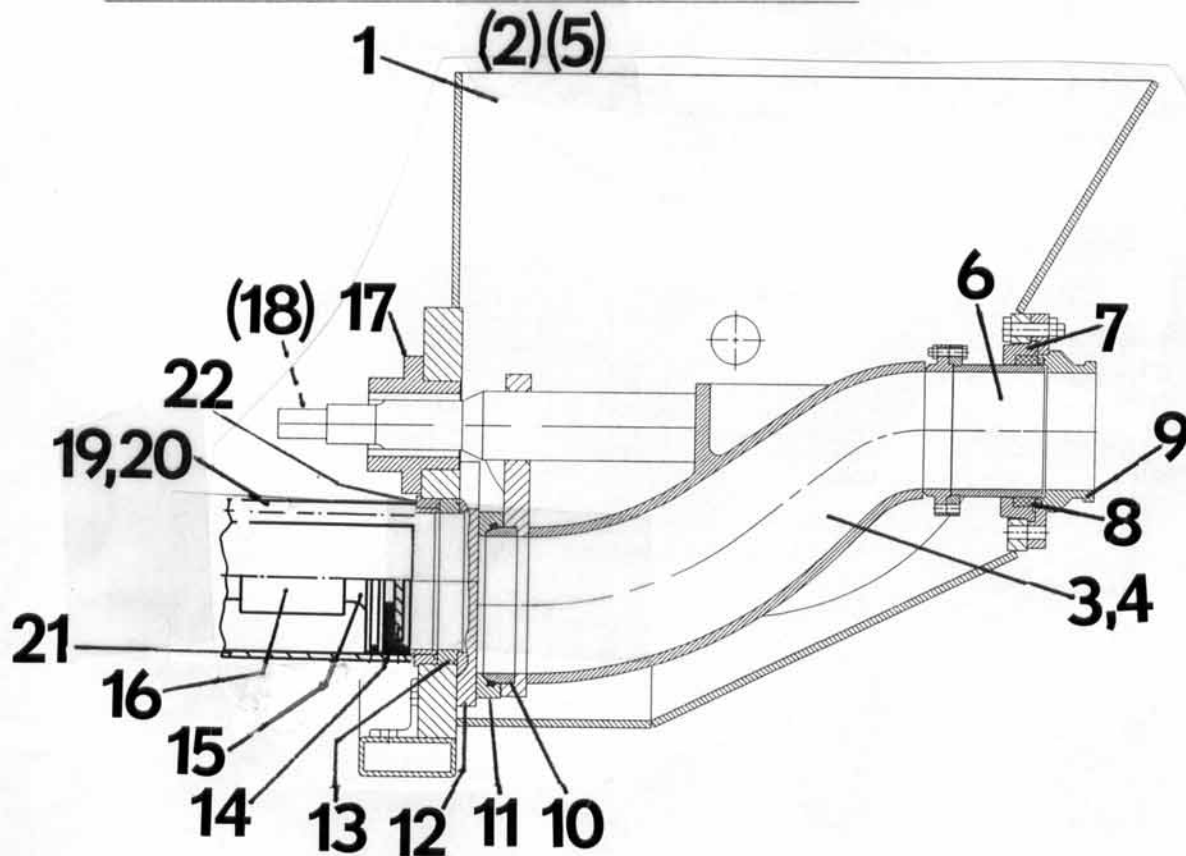

<u>ITEM</u>	<u>DESCRIPTION</u>	<u>PART #</u>
1	HOPPER	75169
2	HOPPER GRATE (not shown)	75236
3	SWINGTUBE ASS'Y (SQUARE SHAFT)	75140
4	SWINGTUBE (CASTING ONLY)	75139
5	SPLASH GUARD	75235
6	OUTLET CHROMED	75188
7	OUTLET SEAL HOUSING	75134
8	OUTLET SEAL	75206
9	6" OUTLET	75136
10	WEAR RING LOCATOR	75209
11	WEAR RING	75207
12	WEAR PLATE (NEW STYLE)	75148
13	ANTI CHIP RING	75131 (2)
14	PISTON CUP 7"	75205 (2)
15	CONCRETE PISTON ADAPTER	70503 (2)
16	PISTON COUPLING	( ) (2)
17	FLANGED BEARING	75197
18	BELL CRANK	75138
19	TIE ROD - CONCRETE CYLINDER (SHORT)	75200 (1)
20	TIE ROD - CONCRETE CYLINDER (LONG)	75201 (5)
21	CONCRETE CYLINDER	75127
22	ADAPTOR RING 7"/6"	75132

HYDRAULIC CYLINDERS - SWINGTUBE

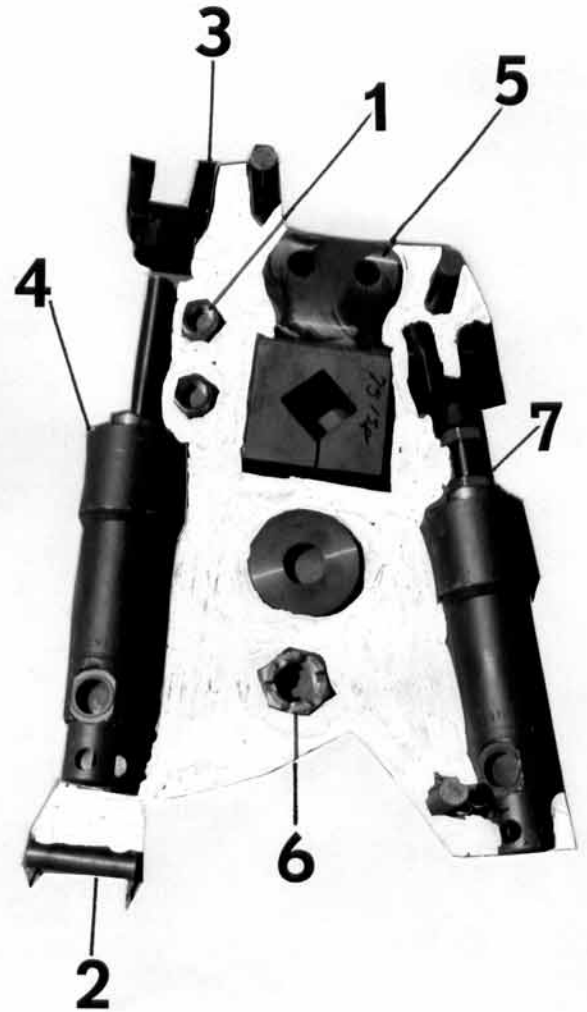

<u>ITEM</u>	<u>DESCRIPTION</u>	<u>PART #</u>
1	HEX NUT SELF LOCKING	80023
2	CLEVIS PIN	N.P.N.
3	CLEVIS	70143
4	HYDRAULIC CYLINDERS	75142
5	BELL CRANK	75138
6	1-1/2" CASTLE HEX NUT	70825
7	JAM NUT 1" UNF (NOT SHOWN) (USED AS LOCK NUT FOR BOTH ROD POSITION)	N.P.N.
-	TAB WASHER (NOT SHOWN) (USED TO LOCK JAM NUT INTO POSITION)	

REAR HYDRAULIC TANK

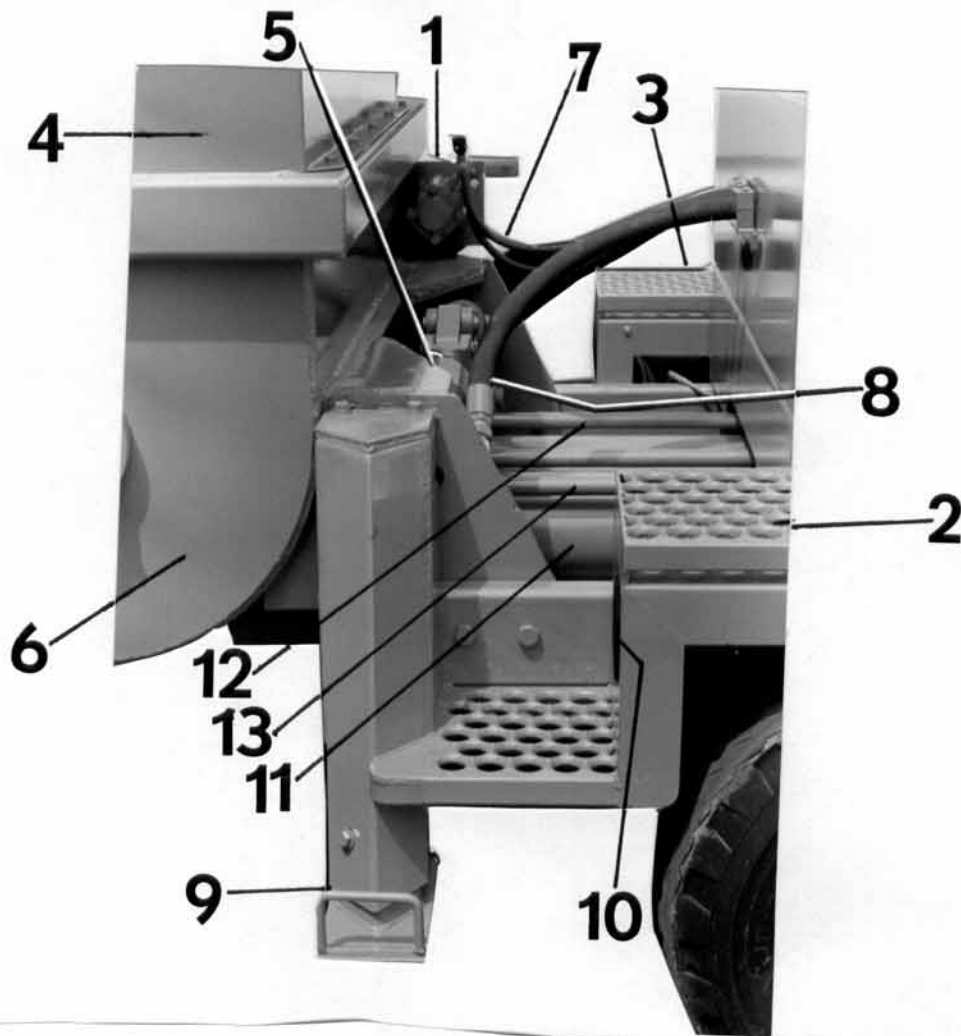

<u>ITEM</u>	<u>DESCRIPTION</u>	<u>PART #</u>
1	AUGER MOTOR	90183
2	FENDER (R.H.)	75241
3	FENDER (L.H.)	75240
4	SPLASH GUARD	75235
5	SWING TUBE HYDRAULIC CYLINDERS	75142
6	HOPPER WELDMENT	75169
7	HOSE	75275
8	HOSE	75304
9	OUTRIGGER (INNER TUBE)	75250
10	TAIL LIGHT	72947
11	CONCRETE CYLINDERS	75127
12	TIE ROD (LONG)	75201
13	TIE ROD (SHORT)	75200

AUGER

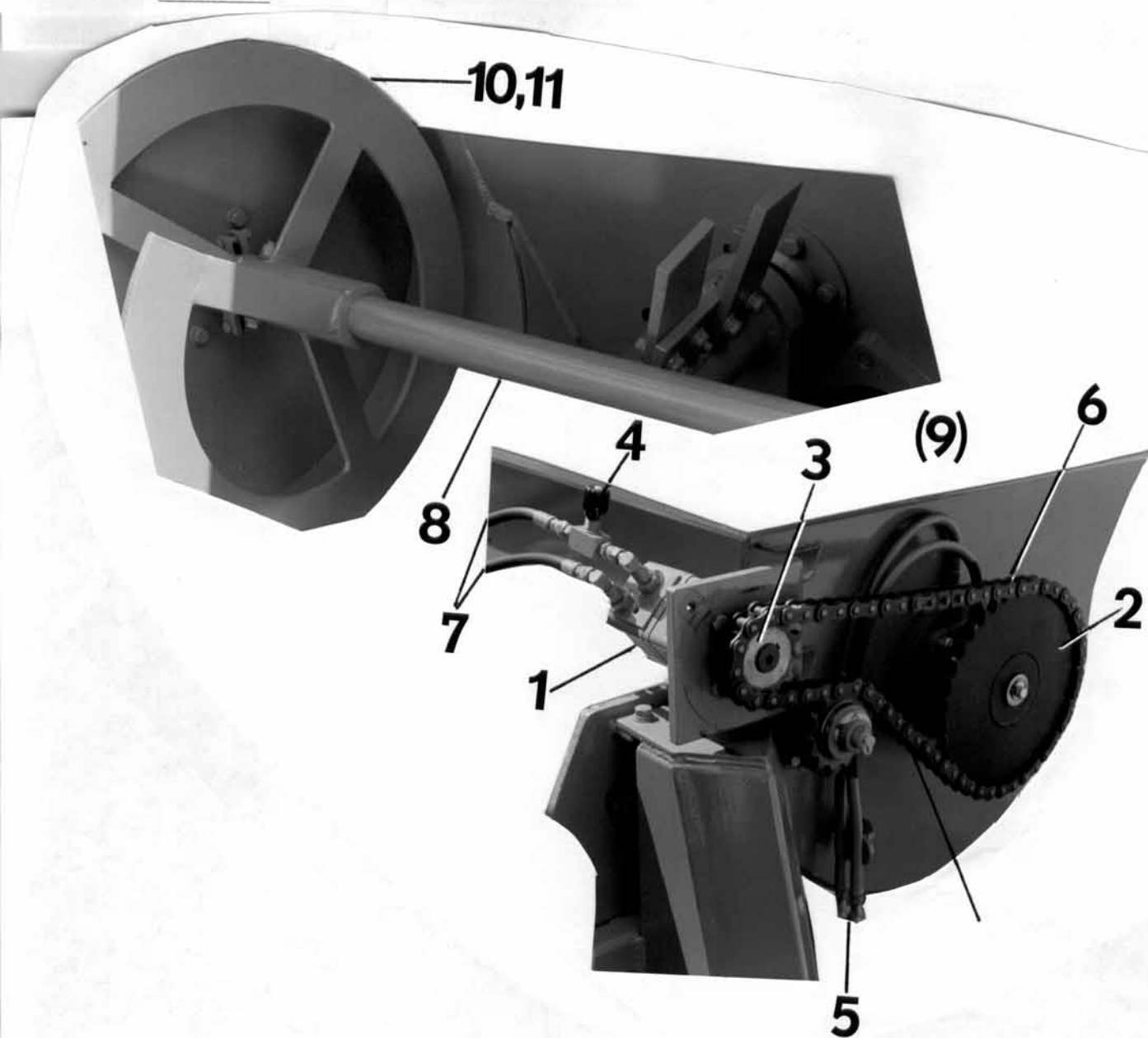

<u>ITEM</u>	<u>DESCRIPTION</u>	<u>PART #</u>
1	REMIXER MOTOR	90183
2	LARGE SPROCKET	75371
3	SMALL SPROCKET	75370
4	FLOW CONTROL VALVE	74514
5	GREASE ZERK HOSES	75275
6	CHAIN	75373
7	HOSE	75313
8	AUGER SHAFT	75351
9	HOPPER GRATE (NOT SHOWN)	75236
10	AUGER FLIGHT (LH)	75168
11	AUGER FLIGHT (RH)	75167

HYDRAULIC PUMPS - SUNDSTRAND/SAUER SERIES 90

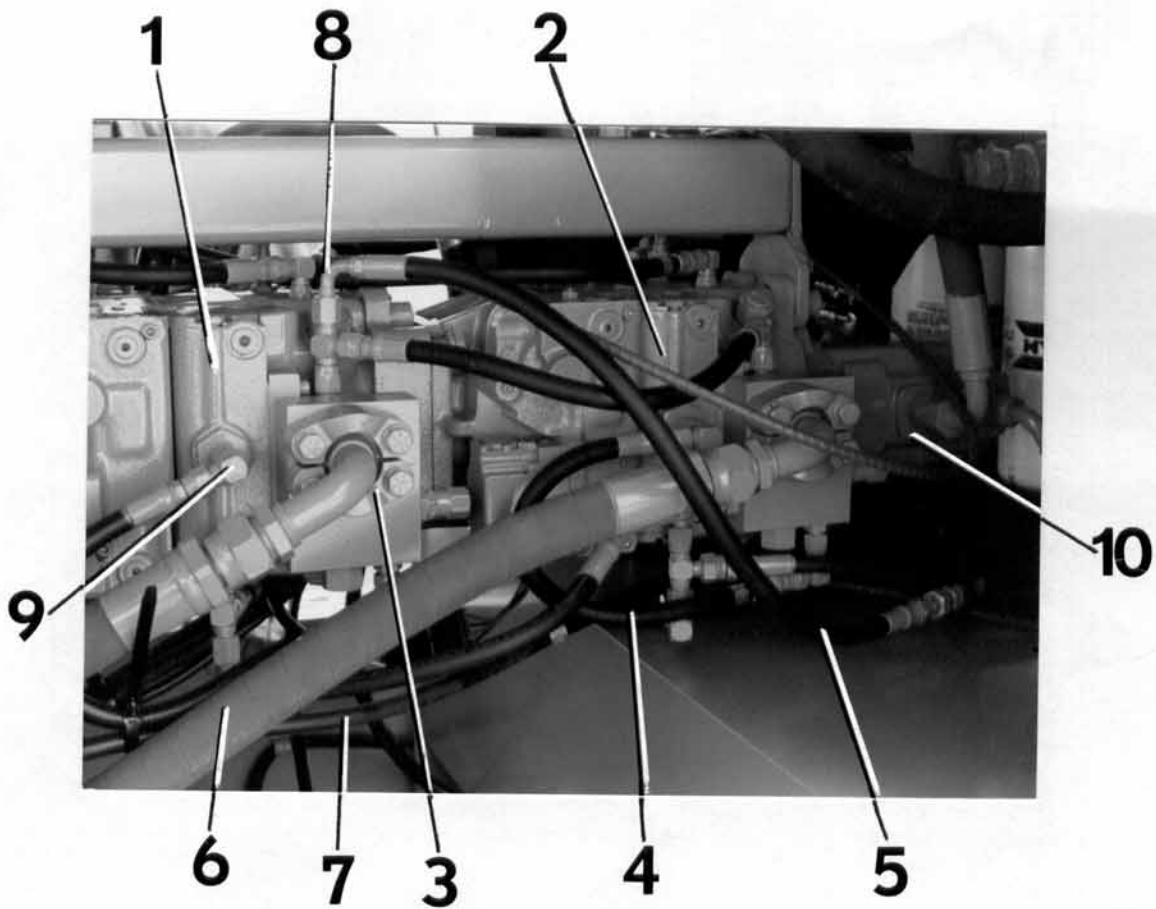

<u>ITEM</u>	<u>DESCRIPTION</u>	<u>PART #</u>
1	FRONT HYDRAULIC PUMP	75122
2	REAR HYDRAULIC PUMP	75123
3	FLANGE KIT	74609
4	HOSE	74619
5	HOSE	74626
6	HOSE	74873
7	HOSE	72715
8	TUBE ELBOW	74845
9	90 DEGREE ADAPTOR	72841
10	AUXILIARY GEAR PUMP	75124

**SUNDSTRAND**  
**SERIES 90 PUMP**

**SERIES 90 PUMPS AND MOTORS - CONFIGURATION**

- \* THE SERIES 90 PUMPS AND MOTORS PROVIDE AN INFINITELY VARIABLE SPEED RANGE BETWEEN ZERO AND MAXIMUM IN BOTH FORWARD AND REVERSE MODES OF OPERATIONS.
- \* THE SERIES 90 VARIABLE DISPLACEMENT PUMP IS A COMPACT, HIGH POWER DENSITY UNIT WITH ADVANCED DESIGN, USING THE PARALLEL AXIAL PISTON / SLIPPER CONCEPT IN CONJUNCTION WITH A TILTABLE CRADLE SWASHPLATE TO VARY THE PUMPS DISPLACEMENT. REVERSING THE ANGLE OF THE SWASHPLATE REVERSES THE FLOW OF OIL FROM THE PUMP AND THUS REVERSES THE DIRECTION OF ROTATION OF THE MOTOR OUTPUT.
- \* THE VARIABLE DISPLACEMENT PUMPS ARE CONTROLLED BY A COMPACT RESPONSIVE CLOSED LOOP SERVO CONTROL WITH A ELECTRICAL INPUT.
- \* THESE PUMPS CONTAIN TWO (2) PATENTED , MULTI-FUNCTION VALVE CARTRIDGES WHICH PROVIDE THE CHECK, PRESSURE LIMITING, HIGH PRESSURE RELIEF AND BYPASS FUNCTIONS.

**TECHNICAL DATA - SERIES 90 PUMPS AND MOTORS**

Temperature at Hottest Point In Transmission (normally at case drain)	
Maximum	°F 240
	°C 115
Continuous	°F 220
	°C 104
Fluid Viscosity Limits - SUS (CST)	
Optimum	70 (13)
Minimum Continuous	47 (6.4)
Minimum Intermittent	42 (5.0)
Maximum Continuous	500 (110)
Maximum Cold Start	7500 (1600)
Fluid Contamination Levels - ISO Code	
Recommended Limit - Continuous Operation	18/13
Limit for Machine Assembly (at roll off)	21/15