

REED

GUNITE MACHINE SPARE PARTS & ACCESSORIES

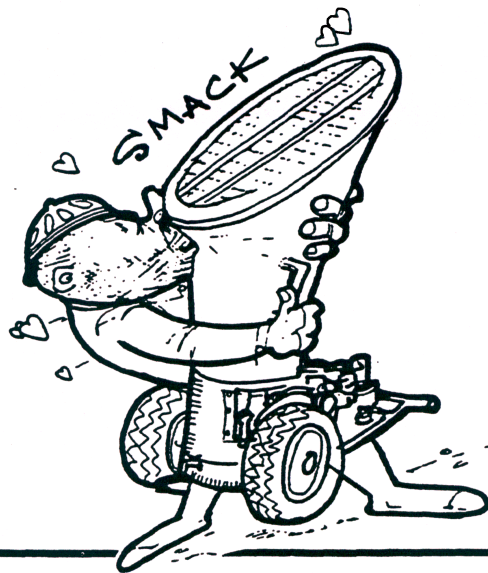

Take care of your REED machine. With a reasonable amount of daily maintenance your gun is built to give many years of high performance under the most severe applications.



REED *Concrete*®





TABLE OF CONTENTS

TERMS AND CONDITIONS.....	2
LIMITED WARRANTY.....	3
GUNITE HOSE.....	4
COUPLING ASSEMBLIES AND ADAPTERS.....	5
NOZZLE ASSEMBLIES.....	7
GUNITE TOOLS AND SUPPLIES	
SPIROLET NOZZLE.....	8
AIR/WATER HOSE.....	8
SHOOTING WIRE.....	8
CUTTING RODS, FRESNOS, TROWELS, FLOATS.....	9
BOOSTER PUMPS.....	10
SAFETY DECALS.....	11
RECOMMENDED SPARE PARTS	
LOVA/LOHE.....	12
LOVA/LOHE – SERIES IV.....	14
SOVA/SOVE.....	16
209A/209E.....	17
215A/215E.....	18
LOVA 8 TO LOVA 16 CHANGEOVER.....	19



TERMS AND CONDITIONS

PRICES, DESIGNS AND TERMS AND CONDITIONS OF SALE ARE SUBJECT TO CHANGE WITHOUT NOTICE.

ALL MATERIAL IS CAREFULLY EXAMINED, COUNTED, AND PACKED BY EXPERIENCED EMPLOYEES. CLAIMS FOR CORRECTIONS MUST BE MADE WITHIN 10 DAYS OF RECEIPT OF GOOD. OUR RESPONSIBILITY CEASES WHEN GOODS ARE DELIVERED TO CARRIER IN GOOD CONDITION AND ITS RECEIPT OBTAINED. CARRIERS ARE RESPONSIBLE FOR GOODS LOST, DAMAGED, OR DELAYED IN TRANSIT. FOR YOUR OWN PROTECTION, HAVE TRANSPORTATION COMPANY'S AGENT VERIFY DAMAGES, SHORTAGES, OR DELAYS AND NOTE THEM ON FREIGHT BILL OVER HIS SIGNATURE.

- ALL WEIGHTS ARE APPROXIMATE SHIPPING WEIGHTS AND SUBJECT TO CHANGE WITHOUT NOTICE.
- PRICES ARE SUBJECT TO CHANGE WITHOUT NOTICE. IN ACCORDANCE WITH OUR ESTABLISHED POLICY OF CONSTANT IMPROVEMENT, WE RESERVE THE RIGHT TO AMEND OUR SPECIFICATIONS AT ANY TIME WITHOUT NOTICE.
- ALL PRICES ARE F.O.B. SHIPPING POINT WITH FREIGHT CHARGES COLLECT.
- GOODS MAY NOT BE RETURNED EXCEPT WITH PRIOR APPROVAL AND ISSUANCE OF RETURN GOODS AUTHORIZATION NUMBER FROM OUR FACTORY. A 15% RESTOCKING CHARGE WILL APPLY TO ALL GOODS RETURNED.

TO PLACE AN ORDER PLEASE CONTACT US AT:

13822 OAKS AVENUE
CHINO, CA 91710 U.S.A.

PHONE: 909-287-2106 OR 909-287-2112
TOLL FREE OUTSIDE CALIFORNIA: 888-779-**REED**

FAX: 909-287-2141

OR CONTACT YOUR LOCAL **REED** DEALER



SPARE PARTS LIMITED WARRANTY

REED warrants each of its replacement parts to be free of defects in material and workmanship under normal use and service for a period of sixty (60) days from date of delivery.

The warranty periods begins when the part is delivered to the initial buyer. Said warranty is void if the machine/parts is subject to misuse, neglect, accident or abuse.

REED'S obligation under this warranty is limited to correcting without charge, at its factory, any parts or parts thereof which shall be returned to its factory, transportation prepaid and upon **REED'S** examination proves to have been originally defective. Correction of such defects by repair or replacement shall constitute fulfillment of all obligations to the buyer. This warranty does not include labor or transportation charges unless specifically identified and authorized in writing by **REED**. Nor does the warranty apply to any part upon which repairs or unauthorized alterations have been made.

This warranty does not apply to normal maintenance service or to normal replacement of certain parts which are subject to normal wear (such as feed bowls, wear plates, wear pads, liners, delivery systems, filters, wear rings, piston cups, etc.). **REED** makes no warranty in respect to trade accessories or outside vendor components, such being subject to the warranties of their respective manufacturers.

THIS IS A LIMITED WARRANTY AND IS IN LIEU OF ANY OTHER WARRANTIES, EXPRESSED OR IMPLIED, INCLUDING ANY WARRANTY OF MERCHANTABILITY OR FITNESS FOR A PARTICULAR PURPOSE. In no event shall **REED** be liable for incidental, general or consequential damages, loss or any expense directly or indirectly related and resulting from use or lack of use caused by delay in delivery, parts failure, or any other causes associated with the use of the part. No person, firm or corporation is authorized to assume for **REED** any other liability in connection with the sale of **REED** products.

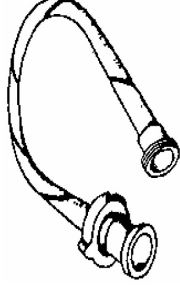

GUNITE MATERIAL HOSE

COUPLED "COARSE"	COUPLED "FINE"	NOT COUPLED	DESCRIPTION	I.D.(IN.)	O.D.(IN.)	WGT./FT Lbs.
N/A	40526	40525	STATIC CONDUCTING WITH STURDY BLACK JACKET	1	1.81	0.90
40532	40531	40530	STATIC CONDUCTING WITH STURDY BLACK JACKET	1.25	2.06	1.22
40537	40502	40535	STATIC CONDUCTING WITH STURDY BLACK JACKET	1.5	2.44	1.54
40452	N/A	40451	NON-STATIC CONDUCTING WITH TAN GUM RUBBER	2	2.94	1.91
40448	N/A	40449	STATIC CONDUCTING WITH TAN JACKET	2	2.94	1.91
40538	N/A	40489	STATIC CONDUCTING WITH TAN JACKET	2.5	3.47	2.38

UPDATED 4/6/2006



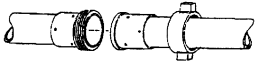

COUPLINGS AND ADAPTERS

CATEGORY	PART#	DESCRIPTION
COUPLING ASSEMBLIES 	11007	2½" COUPLING ASSEMBLY – COARSE
	11006	2" COUPLING ASSEMBLY – COARSE
	use 1101211004 OBS	1½" COUPLING ASSEMBLY – FINE (2 3/8" O.D.)
	use 1101211003 OBS	1½" COUPLING ASSEMBLY – FINE (2½" O.D.)
	11012	1½" COUPLING ASSEMBLY – COARSE (2 3/8" O.D.)
	11011	1½" COUPLING ASSEMBLY – COARSE (2½" O.D.)
	11002	1¼" COUPLING ASSEMBLY – FINE
	11010	1¼" COUPLING ASSEMBLY – COARSE
	11001	1" COUPLING ASSEMBLY – FINE
	11000	¾" COUPLING ASSEMBLY - FINE

CATEGORY	PART#	DESCRIPTION
HOSE ENDS 	11047	2½" MALE HOSE END – COARSE
	11046	2" MALE HOSE END – COARSE
	11043	1½" MALE HOSE END – FINE (2½" O.D.)
	11044	1½" MALE HOSE END – FINE (2 3/8" O.D.)
	11049	1½" MALE HOSE END – COARSE (2½" O.D.)
	11050	1½" MALE HOSE END – COARSE (2 3/8" O.D.)
	11042	1¼" MALE HOSE END – FINE
	11048	1¼" MALE HOSE END – COARSE
	11041	1" MALE HOSE END – FINE
	11040	¾" MALE HOSE END - FINE
	11022	2½" FEMALE HOSE END
	11021	2" FEMALE HOSE END





COUPLINGS AND ADAPTERS

CATEGORY	PART#	DESCRIPTION
HOSE ENDS (CONT.) 	11018	1½" FEMALE HOSE END
	11019	1½" FEMALE HOSE END
	11023	1¼" FEMALE HOSE END – COARSE
	11017	1¼" FEMALE HOSE END – FINE
	11016	1" FEMALE HOSE END
	11015	¾" FEMALE HOSE END
CATEGORY	PART#	DESCRIPTION
COUPLING NUTS (NOT SHOWN)	11034	2½" COUPLING NUT – COARSE
	11033	2" COUPLING NUT – COARSE
	11031	1½" COUPLING NUT – FINE
	11037	1½" COUPLING NUT – COARSE
	11030	1¼" COUPLING NUT – FINE
	11036	1-1/4" COUPLING NUT – COARSE
CATEGORY	PART#	DESCRIPTION
GOOSENECK ADAPTERS 	12085	1¼" COARSE TO 1¼" FINE (USED TO REDUCE DOWN TO 1" OR ¾" HOSE)
	12087	2" TO 2½" (USE TO INCREASE TO 2½" HOSE)
	12088	2" TO 1½" (USE TO REDUCE DOWN TO 1½")
	40078	1¼" TO 1½" (USE TO INCREASE TO 1½")

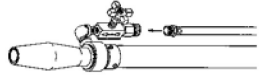
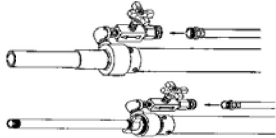

NOZZLE ASSEMBLIES AND ACCESSORIES

CATEGORY	PART#	DESCRIPTION
NOZZLE ASSEMBLIES 	12006	2½" NOZZLE ASSEMBLY – STANDARD – COARSE
	12005	2" NOZZLE ASSEMBLY – STANDARD – COARSE
	12010	1½" NOZZLE ASSEMBLY – STANDARD – COARSE
	12009	1¼" NOZZLE ASSEMBLY – STANDARD - FINE
	12009	1¼" NOZZLE ASSEMBLY – STANDARD - COARSE
	11980	2" HYDRO NOZZLE ASSEMBLY – MINE VERSION – (10 FOOT), COARSE
	40539	2" HYDRO NOZZLE ASSEMBLY – COARSE
	12092	2" HYDRO NOZZLE ASSEMBLY(DBL WATER RING)
	12036	1½" HYDRO NOZZLE ASSEMBLY - COARSE
	11981 12092	1¼" HYDRO NOZZLE ASSEMBLY - COARSE
	12001	1" NOZZLE ASSEMBLY – FINE
	12000	¾" NOZZLE ASSEMBLY-FINE
	11801	1" LANCE NOZZLE ASSEMBLY – FINE
	12022	1½" DOUBLE BUBBLE NOZZLE ASSEMBLY – COARSE
	12021	1¼" DOUBLE BUBBLE NOZZLE ASSEMBLY – COARSE
	12078	1½" DOUBLE BUBBLE HYDRO NOZZLE ASSEMBLY – COARSE

UPDATED 10/09/2008

NOT SUPPLIED BY REED

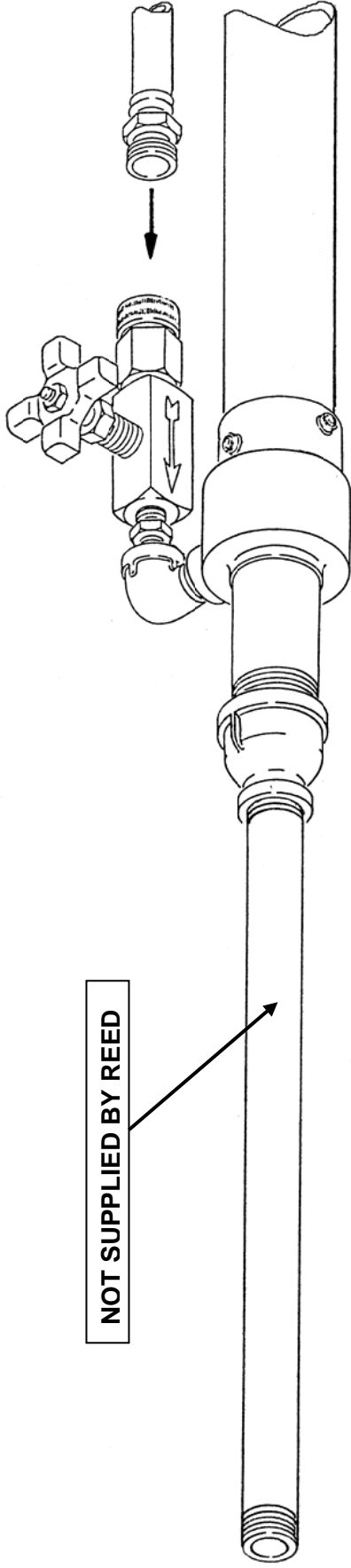

GENERAL NOTES:

ON ITEM #7-PN 12041 LINER IS TO BE TRIMMED SHORT TO FIT INSIDE THE BELL REDUCER.

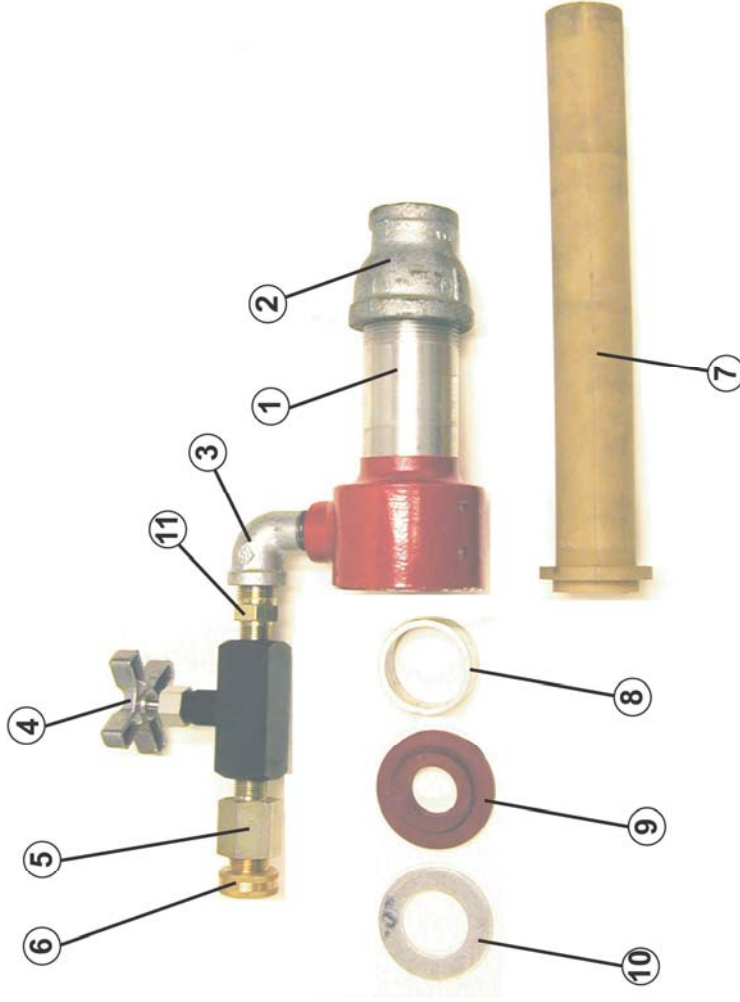

BILL OF MATERIALS

- # 1-PN 11813 BODY-NOZZLE, LANCE (QTY-1)
- # 2-PN 11810 BELL REDUCER 1 1/2" TO 1" (QTY-1)
- # 3-PN 10204 STREET ELBOW 90 -1/2" (QTY-1)
- # 4-PN 11029 VALVE NEEDLE-3/8" (QTY-1)
- # 5-PN 74675 REDUCER-1/2" TO 3/8" (QTY-1)
- # 6-PN 12061 ADAPTER-1/2" TO 3/4" (QTY-1)
- # 7-PN 12041 LINER-1" NOZZLE (QTY-1)
- # 8-PN 12064 WATER RING-1" (QTY-1)
- # 9-PN 12070 WASHER-BACKUP "FINE" (QTY-1)
- #10-PN 12080 WASHER-RETAINER 1 1/4" (QTY-1)
- #11-PN NPN MP-MP-8-6 STR FITTING (QTY-1)

REED CONCRETE PLACING EQUIPMENT
CHINO, CA 91710

TITLE: NOZZLE-LANCE ASSY-FINE
DRAWN BY: EYBARRA 8/25/03

PART NUMBER
11801
SHT 1 OF 1

REV

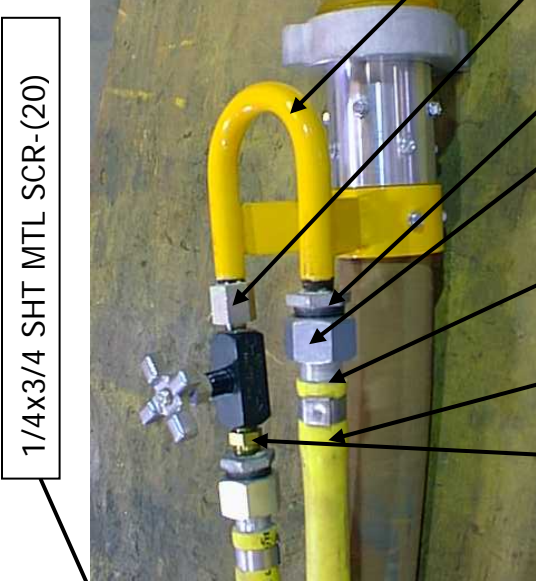

19

15

16

17

18

14

5

13

13

8

7

6

12

9

10

11

4

11

2

1

NOTE-B

- #1- PN 12004 NOZZLE TIP-2 "
- #2- PN 11033 NUT-COUPLING CRSE 2"
- #3- PN 40449 HOSE-2" GUNCRETE
- #4- PN 11021 END-HOSE-CRSE 2"
- #5- PN 11046 END-HOSE MALE-CRSE 2"
- #6- PN 11986 HOSE-GORILLA 1 3/16 X 3/4
- #7- PN 11989 HOSE BARB-3/4 MINE TYPE
- #8- PN 11987 NUT-SPUD 1" MINING

- #9- PN 12063 HANDLE-HYDRO NOZ
- #10- PN 74675 REDUCER-1/2 X 3/8
- #11- PN 11029 VALVE NEEDLE 3/8
- #12- PN 74890 ADAPTOR-1/2 NTPM X 3/8 NPTM
- #13- PN 10225 REDUCER-1 1/2
- #14- PN 12056 BODY-NOZZLE 2" CRSE
- #15- PN 12066 RING-2" WATER
- #16- PN 12074 WASHER-BACKUP 2" CRSE

- #17- PN 12083 WASHER-RETAINER 2"
- #18- PN 10232 NIPPLE-1" X 2"
- #19- ADAPTER-1/2MP X 1/2MP

HOSE ASSEMBLY NOTES:
 A. HOSE O/A LENGTH TO BE 10 FT.
 B. THIS END OF HOSE TO PROTRUDE 1/16" PAST PN 11021 FOR SEAL.

REED CONCRETE PLACING EQUIPMENT
 CHINO, CA 91710

TITLE: HYDRO-NOZZLE ASSY-2 IN
DRAWN BY: EYBARRA 7/7/2000

ECN# 202
 7/7/00
 EMY

PART NUMBER
11980
 SHT 1 OF 1

REV
A

HYDRO NOZZLE (5.5 FEET)

Available in 1.25"

Hamm (11981) complete assembly

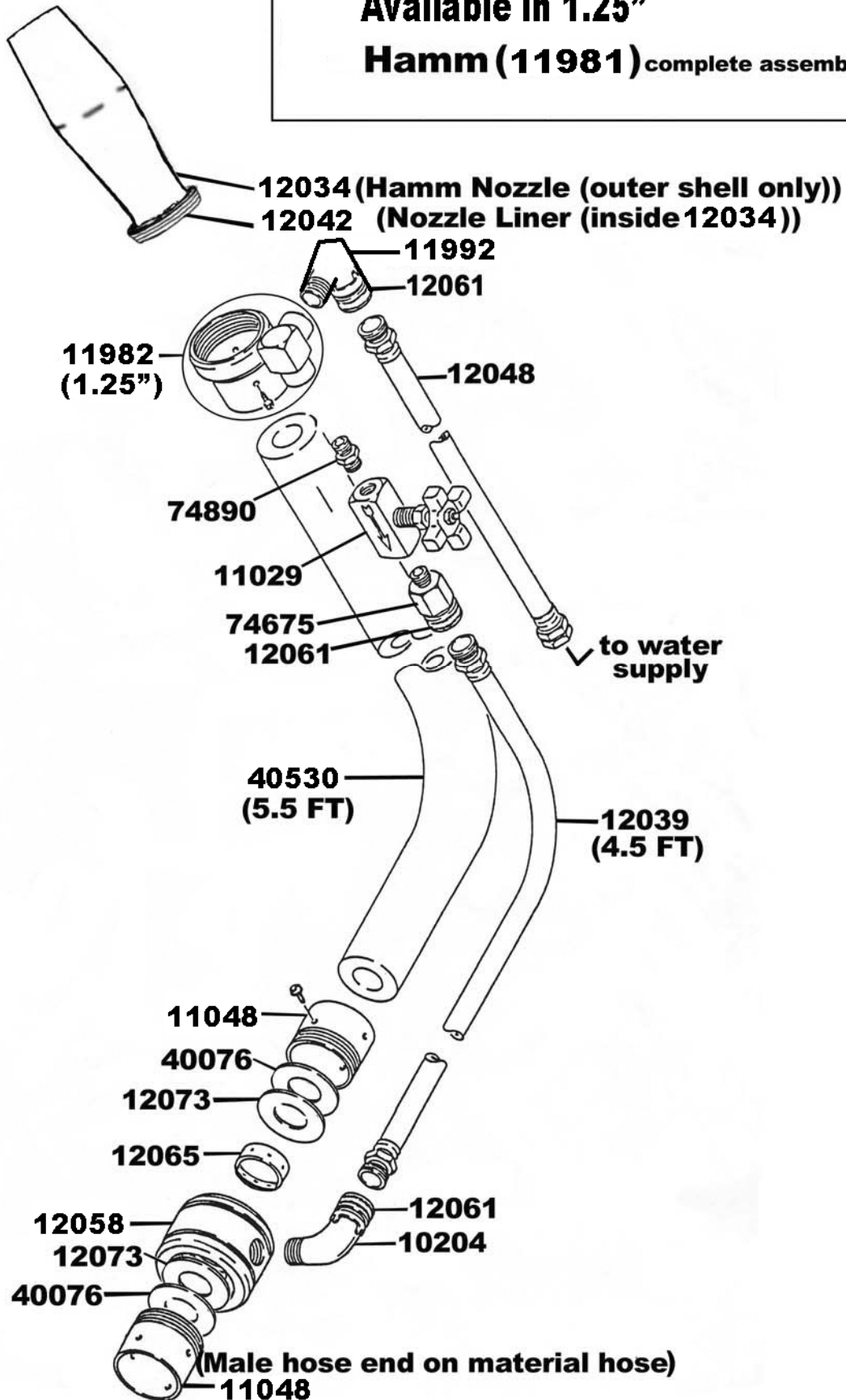

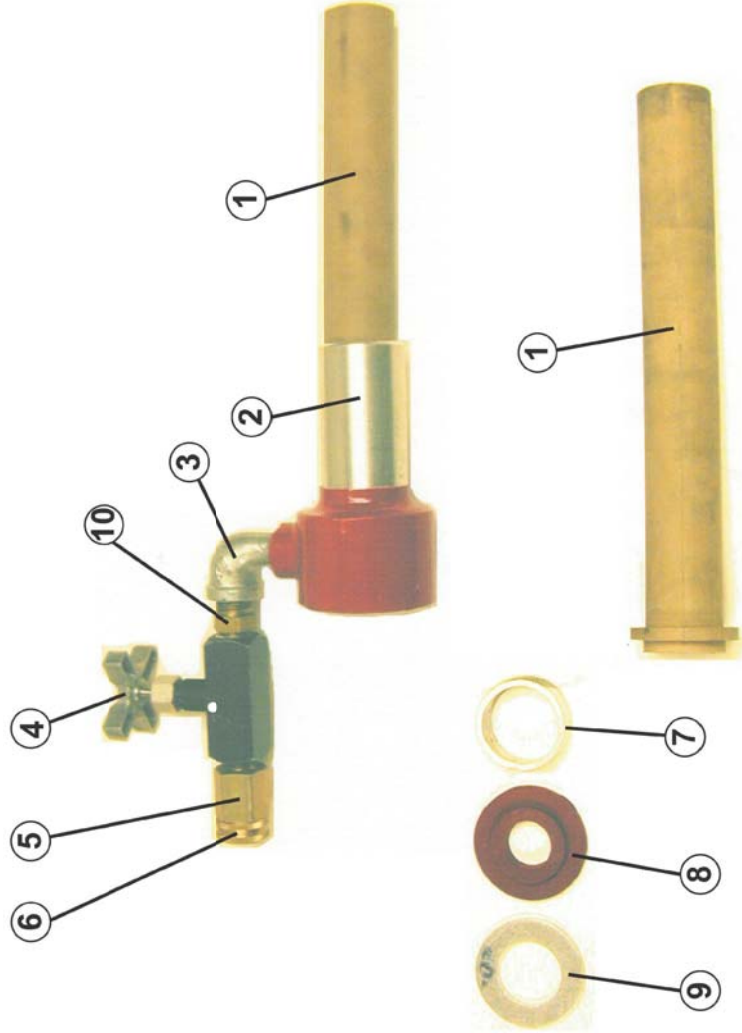
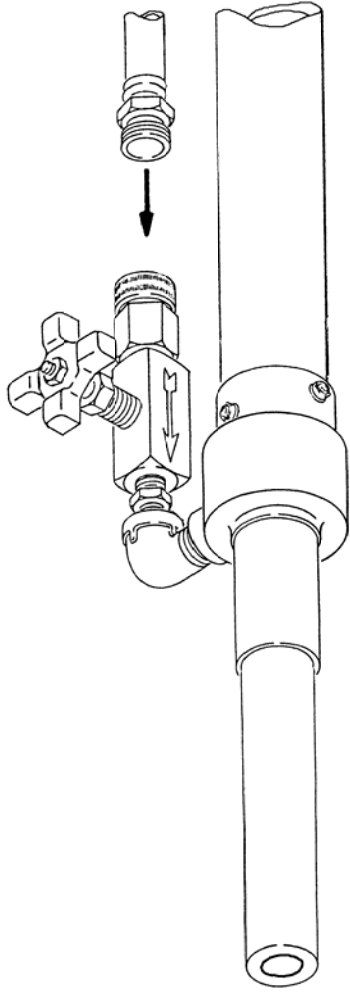

BILL of MATERIALS

- # 2-PN 12052 BODY-NOZZLE 3/4" & 1" FINE (QTY-1)
- # 3-PN 10204 STREET ELBOW 90 -1/2" (QTY-1)
- # 4-PN 11029 VALVE NEEDLE-3/8" (QTY-1)
- # 5-PN 74675 REDUCER-1/2" TO 3/8" (QTY-1)
- # 6-PN 12061 ADAPTER-1/2" TO 3/4" (QTY-1)
- # 7-PN 12064 WATER RING-1" (QTY-1)
- # 8-PN 12070 WASHER-BACKUP "FINE" (QTY-1)
- # 9-PN 12080 WASHER-RETAINER 1 1/4" (QTY-1)
- #10-PN 74890 ADAPTER-1/2" x 3/8" (QTY-1)

REED CONCRETE PLACING EQUIPMENT
 CHINO, CA 91710

TITLE: NOZZLE ASSY-FINE 3/4"
 DRAWN BY: EYBARRA 9/02/03

PART NUMBER
12000
 SHT 1 OF 1

REV

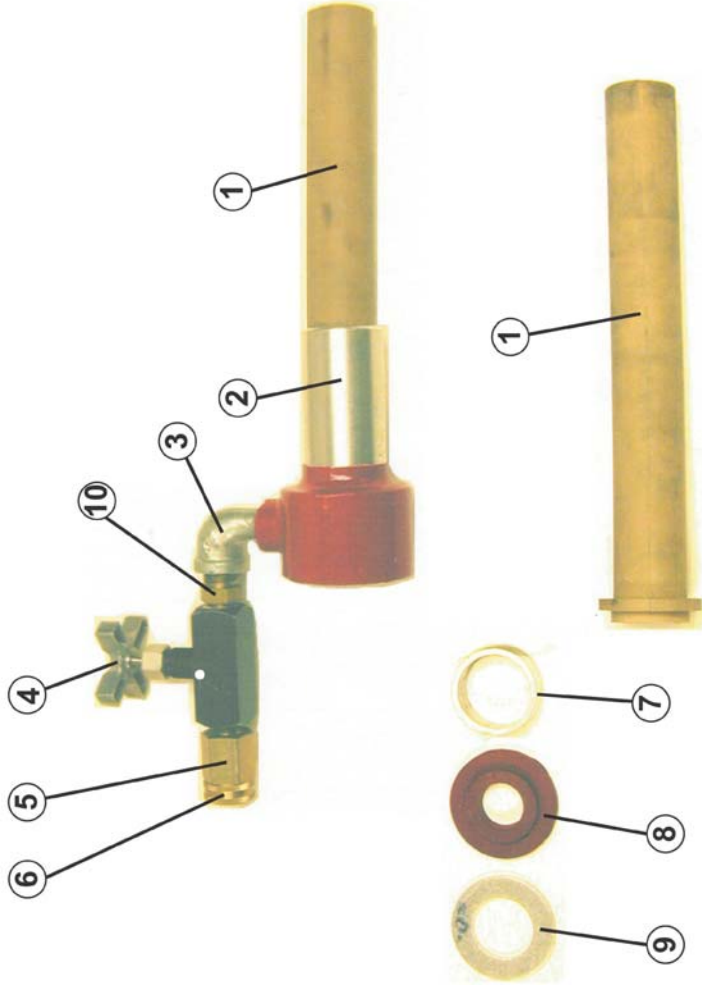
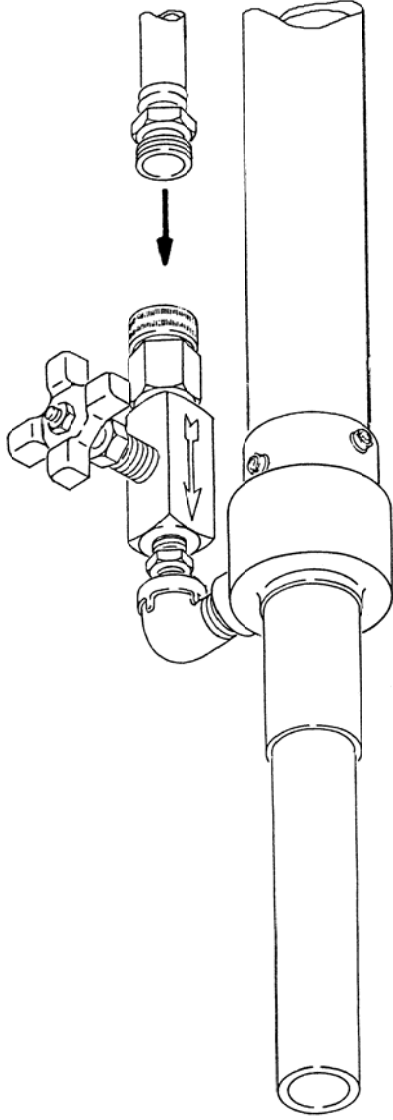

BILL of MATERIALS

#	1-PN 12041 LINER-1" NOZZLE (QTY-1)
#	2-PN 12052 BODY-NOZZLE 1" FINE (QTY-1)
#	3-PN 10204 STREET ELBOW 90 -1/2" (QTY-1)
#	4-PN 11029 VALVE NEEDLE-3/8" (QTY-1)
#	5-PN 74675 REDUCER-1/2" TO 3/8" (QTY-1)
#	6-PN 12061 ADAPTER-1/2" TO 3/4" (QTY-1)
#	7-PN 12064 WATER RING-1" (QTY-1)
#	8-PN 12070 WASHER-BACKUP "FINE" (QTY-1)
#	9-PN 12080 WASHER-RETAINER 1 1/4" (QTY-1)
#	10-PN 74890 ADAPTER-1/2" x 3/8" (QTY-1)

<p>REED CONCRETE PLACING EQUIPMENT CHINO, CA 91710</p>	<p>TITLE: NOZZLE ASSY-FINE 1" DRAWN BY: EYBARRA 8/26/03</p>	<p>PART NUMBER 12001 SHT 1 OF 1</p>	<p>REV</p>
	<p> </p>		

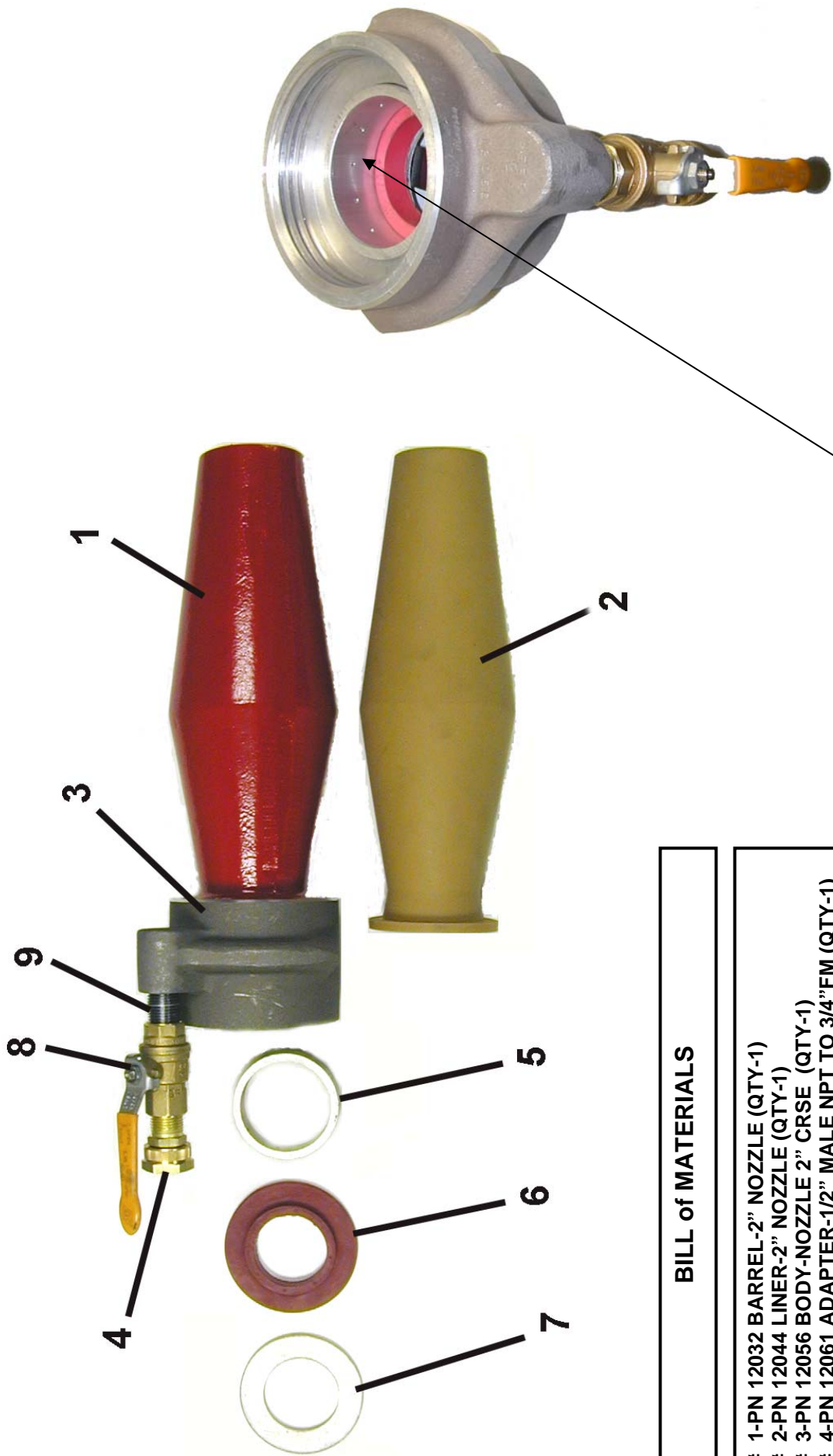

WATER RING INSTALLATION INSTRUCTIONS
 ITEM #5 WATER RING IS INSERTED INTO ITEM #3 NOZZLE BODY FROM THE NOZZLE BARREL END. (METHOD DONE SINCE 9/1990)

BILL of MATERIALS

- # 1-PN 12032 BARREL-2" NOZZLE (QTY-1)
- # 2-PN 12044 LINER-2" NOZZLE (QTY-1)
- # 3-PN 12056 BODY-NOZZLE 2" CRSE (QTY-1)
- # 4-PN 12061 ADAPTER-1/2" MALE NPT TO 3/4"FM (QTY-1)
- # 5-PN 12066 RING-2" WATER (QTY-1)
- # 6-PN 12074 WASHER-BACKUP 2" CRSE (QTY-1)
- # 7-PN 12083 WASHER-RETAINER 2" CRSE ALUM (QTY-1)
- # 8-PN 10270 BALL VALVE-1/2" (QTY-1)
- # 9-PN 10268 CLOSE PIPE NIPPLE-1/2" (QTY-1)

REED CONCRETE PLACING EQUIPMENT
 CHINO, CA 91710

TITLE: NOZZLE ASSY-CRSE 2"
 DRAWN BY: EYBARRA 11/19/04

ECN #979
 11/19/04-EMY

PART NUMBER
12005
 SHT 1 OF 1

REV
A

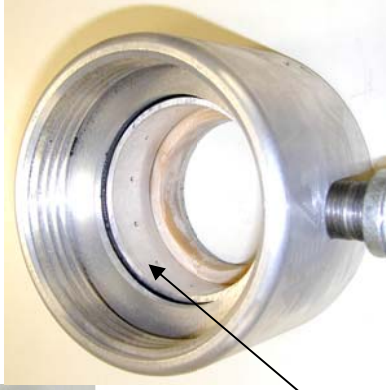
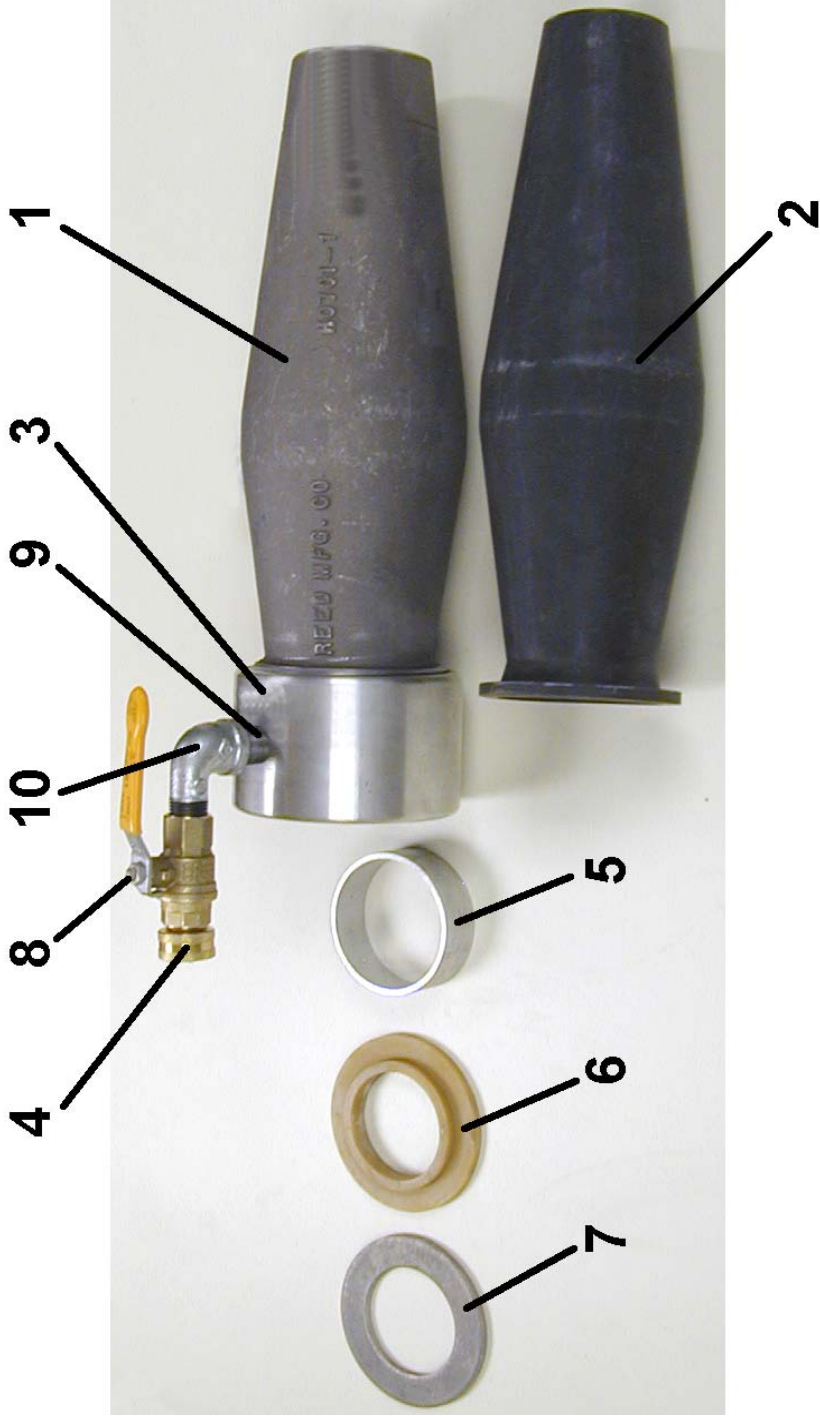

WATER RING INSTALLATION INSTRUCTIONS
 ITEM #5 WATER RING IS INSERTED INTO ITEM #3 NOZZLE BODY FROM THE NOZZLE BARREL END

- BILL of MATERIALS**
- # 1-PN 12033 BARREL-2 1/2" NOZZLE (QTY-1)
 - # 2-PN 12045 LINER-2 1/2" NOZZLE (QTY-1)
 - # 3-PN 12057 BODY-NOZZLE 2 1/2" CRSE (QTY-1)
 - # 4-PN 12061 ADAPTER-1/2" MALE NPT TO 3/4"FM (QTY-1)
 - # 5-PN 12067 RING-2 1/2" WATER (QTY-1)
 - # 6-PN 12075 WASHER-BACKUP 2 1/2" CRSE (QTY-1)
 - # 7-PN 12084 WASHER-RETAINER 2 1/2" CRSE (QTY-1)
 - # 8-PN 10270 BALL VALVE-1/2" (QTY-1)
 - # 9-PN 10268 CLOSE PIPE NIPPLE-1/2" (QTY-1)
 - # 10-PN 10204 STREET ELBOW-90-1/2" (QTY-1)

REED CONCRETE PLACING EQUIPMENT
 CHINO, CA 91710

TITLE: NOZZLE ASSY-CRSE 2 1/2"
 DRAWN BY: EYBARRA 11/14/07

ECN #1241
 11/16/07-EMY

PART NUMBER
12006
 SHT 1 OF 1

REV

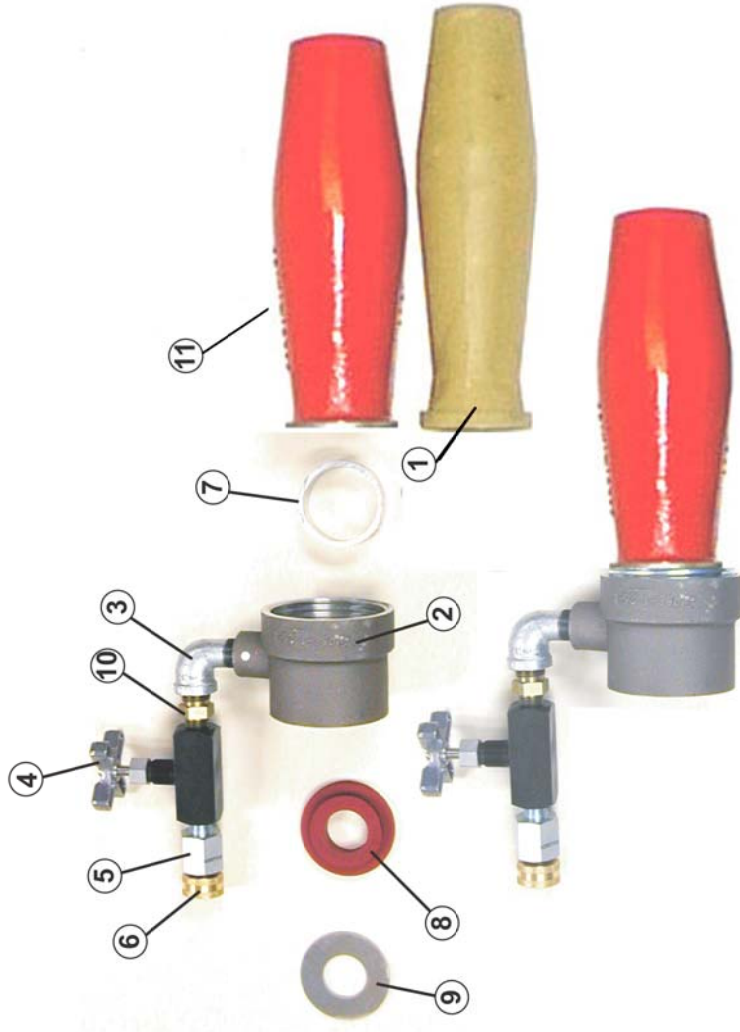
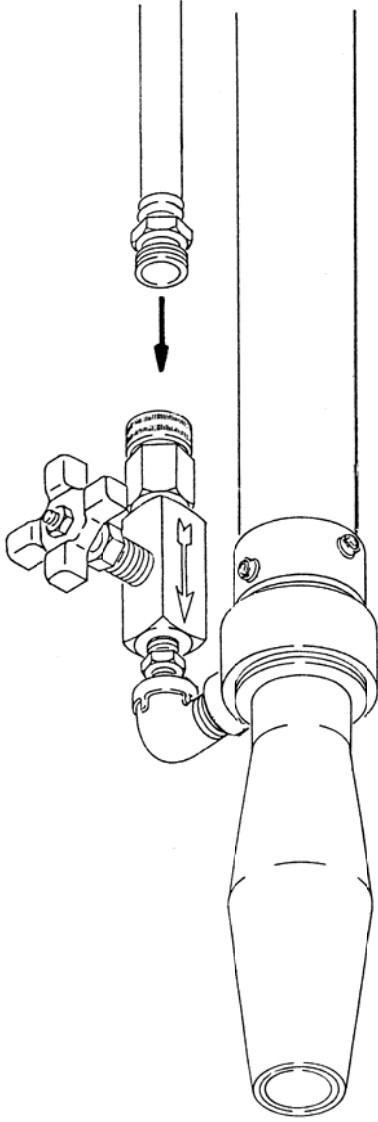

BILL of MATERIALS

- # 2-PN 12058 BODY-NOZZLE 1 1/4" CRSE (QTY-1)
- # 3-PN 10204 STREET ELBOW 90 -1/2" (QTY-1)
- # 4-PN 11029 VALVE NEEDLE-3/8" (QTY-1)
- # 5-PN 74675 REDUCER-1/2" TO 3/8" (QTY-1)
- # 6-PN 12061 ADAPTER-1/2" TO 3/4" (QTY-1)
- # 7-PN 12065 WATER RING-1 1/4" & 1 1/2" (QTY-1)
- # 8-PN 12069 WASHER-BACKUP 1 1/4" CRSE (QTY-1)
- # 9-PN 12079 WASHER-RETAINER 1 1/4" (QTY-1)
- #10-PN 74890 ADAPTER-1/2" x 3/8" (QTY-1)
- #11-PN 12035 BARREL-NOZZLE CRSE 1 1/2" (QTY-1)

REED CONCRETE PLACING EQUIPMENT
CHINO, CA 91710

TITLE: NOZZLE ASSY-COARSE 1 1/4"
DRAWN BY: EYBARRA 10/9/2008

PART NUMBER
12009
SHT 1 OF 1

REV

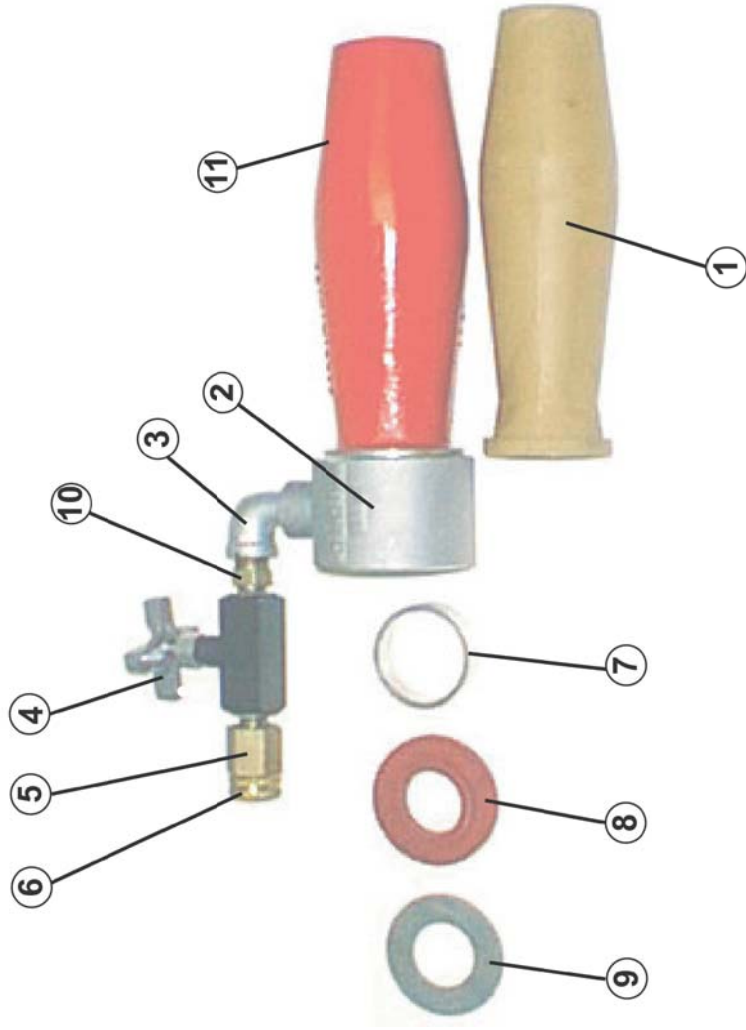
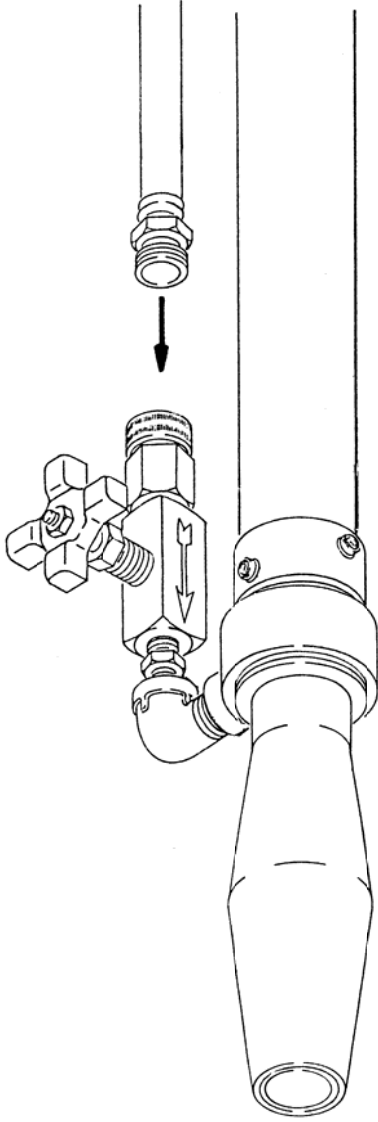

BILL of MATERIALS

- # 1-PN 12043 LINER-1 1/2" NOZZLE (QTY-1)
- # 2-PN 12059 BODY-NOZZLE 1 1/2" CRSE (QTY-1)
- # 3-PN 10204 STREET ELBOW 90 -1/2" (QTY-1)
- # 4-PN 11029 VALVE NEEDLE-3/8" (QTY-1)
- # 5-PN 74675 REDUCER-1/2" TO 3/8" (QTY-1)
- # 6-PN 12061 ADAPTER-1/2" TO 3/4" (QTY-1)
- # 7-PN 12065 WATER RING-1 1/4" & 1 1/2" (QTY-1)
- # 8-PN 12073 WASHER-BACKUP 1 1/2" CRSE (QTY-1)
- # 9-PN 40076 WASHER-RETAINER 1 1/2" (QTY-1)
- #10-PN 74890 ADAPTER-1/2" x 3/8" (QTY-1)
- #11-PN 12035 BARREL-NOZZLE CRSE 1 1/2" (QTY-1)

<p>REED CONCRETE PLACING EQUIPMENT CHINO, CA 91710</p>	<p>TITLE: NOZZLE ASSY-COARSE 1 1/2" DRAWN BY: EYBARRA 8/29/03</p>		<p>PART NUMBER 12010 SHT 1 OF 1</p>	<p>REV</p>

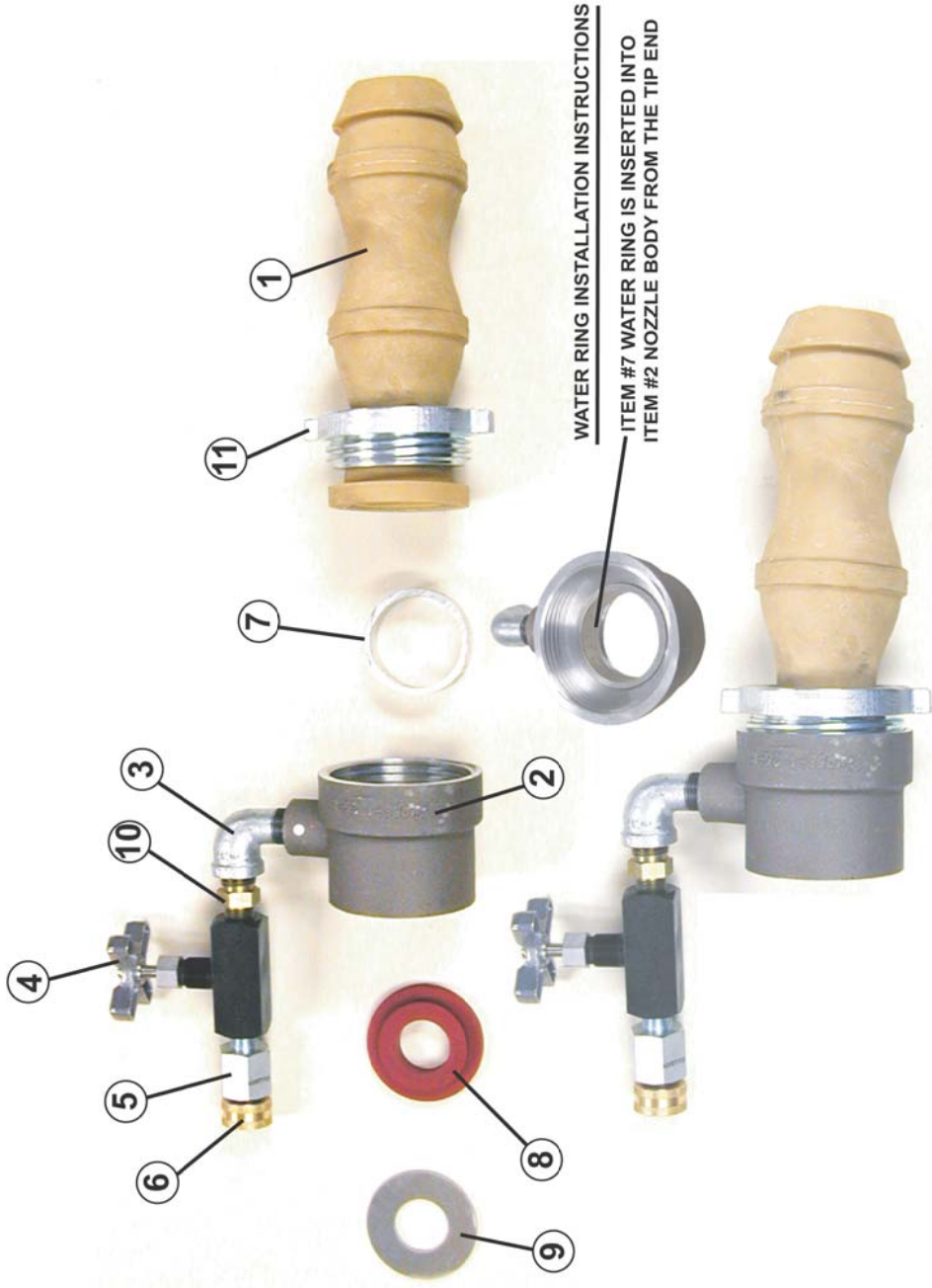

WATER RING INSTALLATION INSTRUCTIONS

ITEM #7 WATER RING IS INSERTED INTO
ITEM #2 NOZZLE BODY FROM THE TIP END

BILL of MATERIALS

- # 1-PN 12047 TIP-1 1/4" DOUBLE BUBBLE (QTY-1)
- # 2-PN 12058 BODY-NOZZLE 1 1/4" CRSE (QTY-1)
- # 3-PN 10204 STREET ELBOW 90 -1/2" (QTY-1)
- # 4-PN 11029 VALVE NEEDLE-3/8" (QTY-1)
- # 5-PN 74675 REDUCER-1/2" TO 3/8" (QTY-1)
- # 6-PN 12061 ADAPTER-1/2" TO 3/4" (QTY-1)
- # 7-PN 12065 WATER RING-1 1/4" & 1 1/2" (QTY-1)
- # 8-PN 12069 WASHER-BACKUP 1 1/4" CRSE (QTY-1)
- # 9-PN 12079 WASHER-RETAINER 1 1/4" (QTY-1)
- # 10-PN 74890 ADAPTER-1/2" x 3/8" (QTY-1)
- # 11-PN 12091 NUT-D.B. RETAINER (QTY-1)

REED CONCRETE PLACING EQUIPMENT
CHINO, CA 91710

TITLE: NOZZLE ASSY 1 1/4" DB
DRAWN BY: EYBARRA 11/16/2007

ECN#1241
11/16/07-EMY

PART NUMBER
12021
SHT 1 OF 1

REV

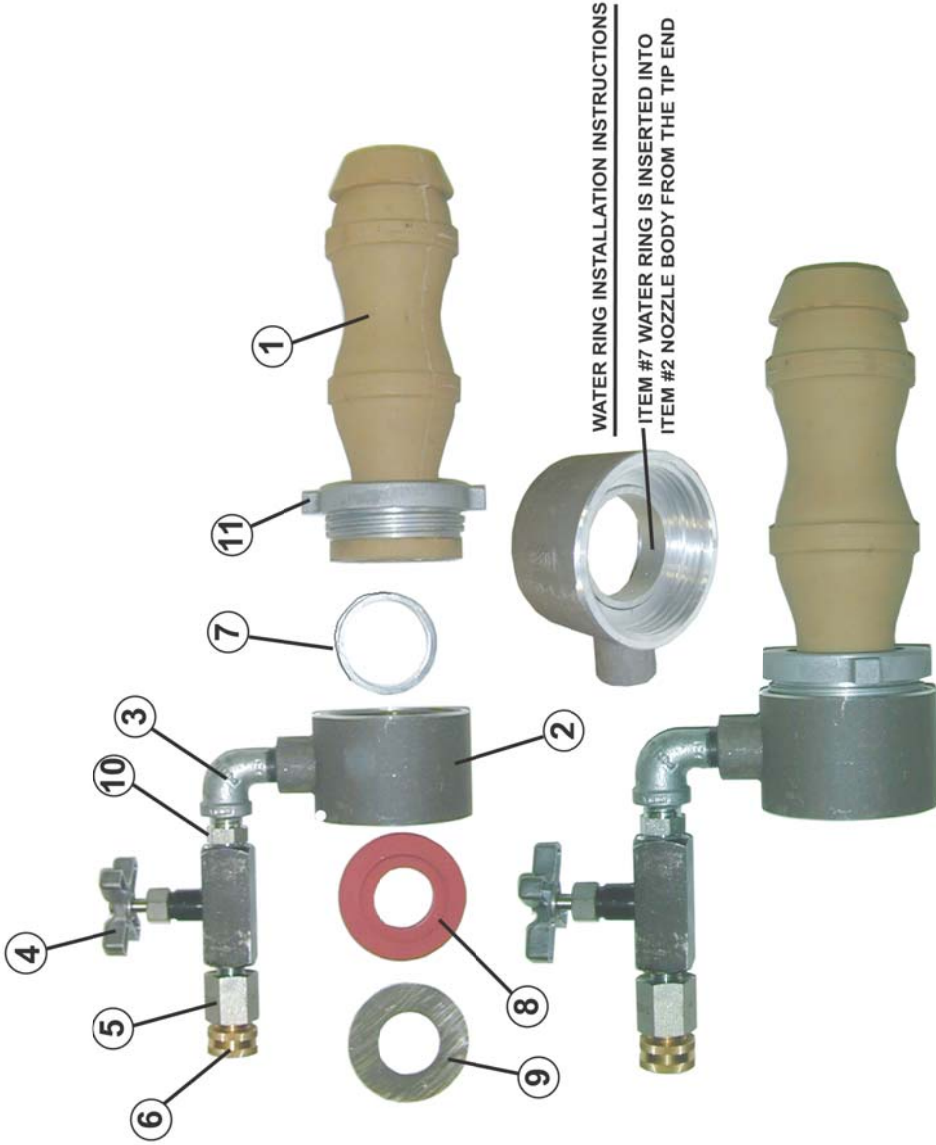

BILL of MATERIALS

- # 1-PN 12047 TIP-1 1/4" DOUBLE BUBBLE (QTY-1)
- # 2-PN 12059 BODY-NOZZLE 1 1/2" CRSE (QTY-1)
- # 3-PN 10204 STREET ELBOW 90 -1/2" (QTY-1)
- # 4-PN 11029 VALVE NEEDLE-3/8" (QTY-1)
- # 5-PN 74675 REDUCER-1/2" TO 3/8" (QTY-1)
- # 6-PN 12061 ADAPTER-1/2" TO 3/4" (QTY-1)
- # 7-PN 12065 WATER RING-1 1/4" & 1 1/2" (QTY-1)
- # 8-PN 12073 WASHER-BACKUP 1 1/2" CRSE (QTY-1)
- # 9-PN 40076 WASHER-RETAINER 1 1/2" (QTY-1)
- # 10-PN 74890 ADAPTER-1/2" x 3/8" (QTY-1)
- # 11-PN 12091 NUT-D.B. RETAINER (QTY-1)

REED CONCRETE PLACING EQUIPMENT
CHINO, CA 91710

TITLE: NOZZLE ASSY 1 1/2" DB
DRAWN BY: EYBARRA 10/09/2008

PART NUMBER
12022
SHT 1 OF 1

REV

HYDRO NOZZLE (5.5 FEET)

Available in 1.5"
Hamm (12036) complete assembly

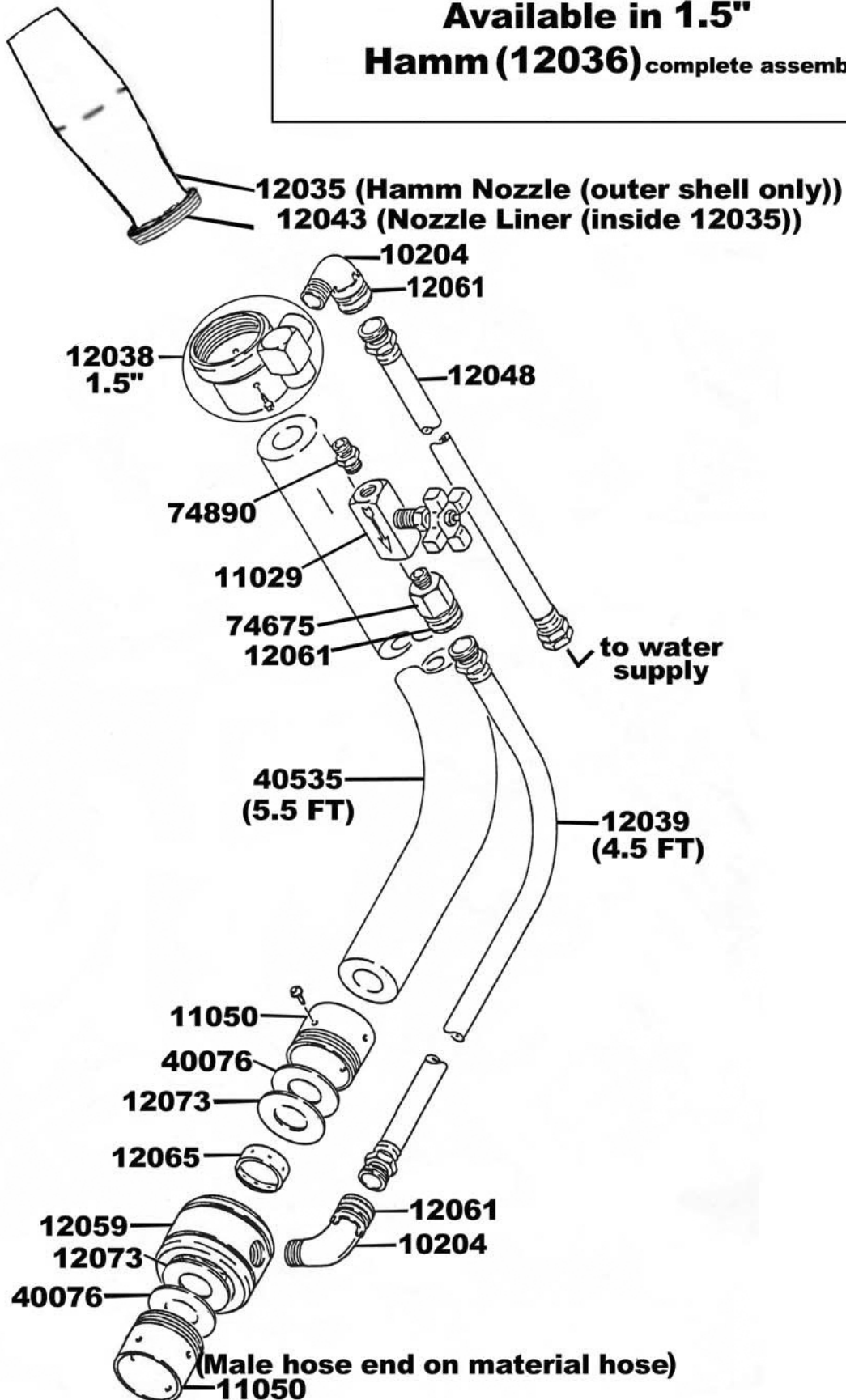

HYDRO NOZZLE (5.5 FEET)

Available in 1.5"
Double Bubble (12078) complete assembly

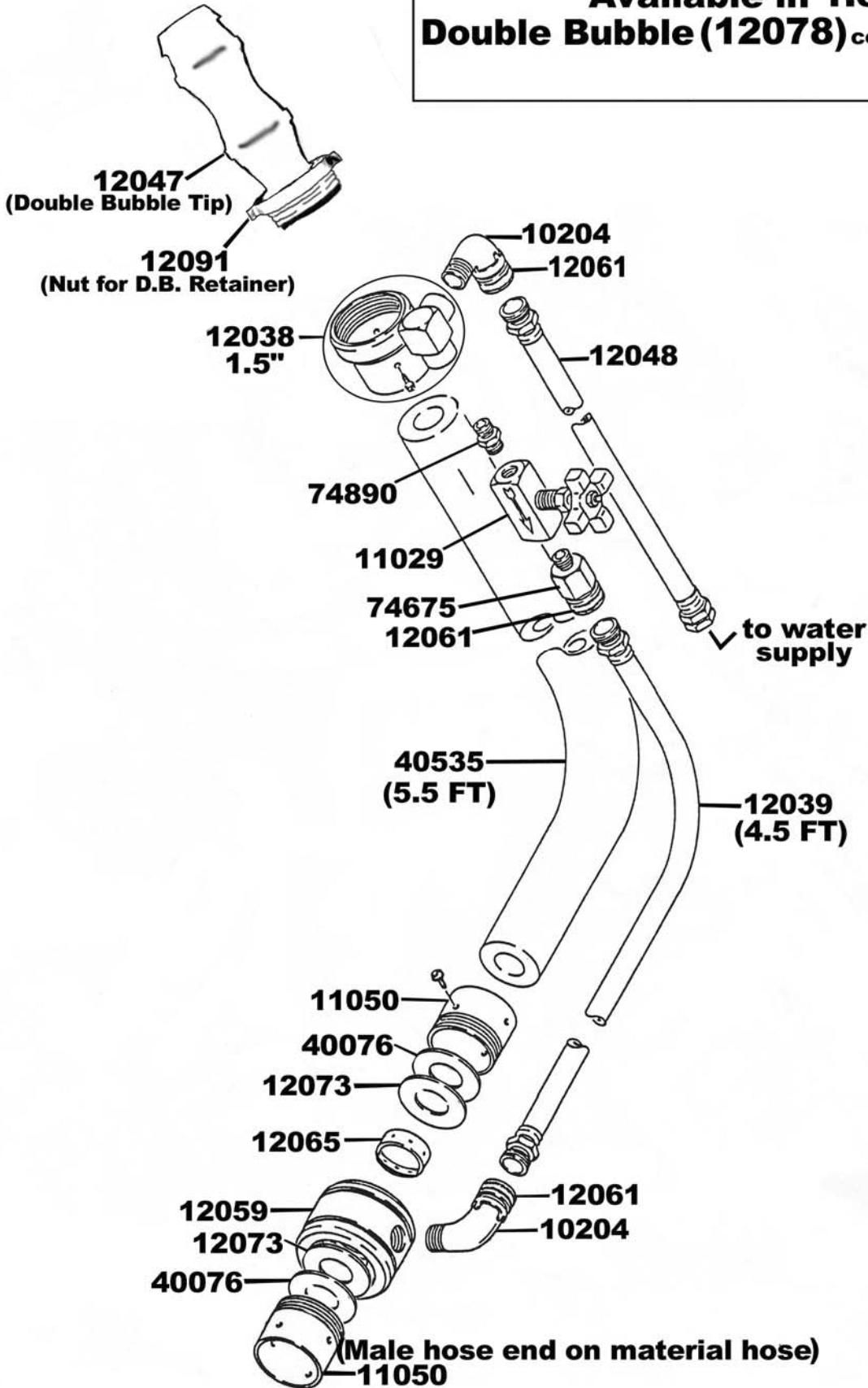

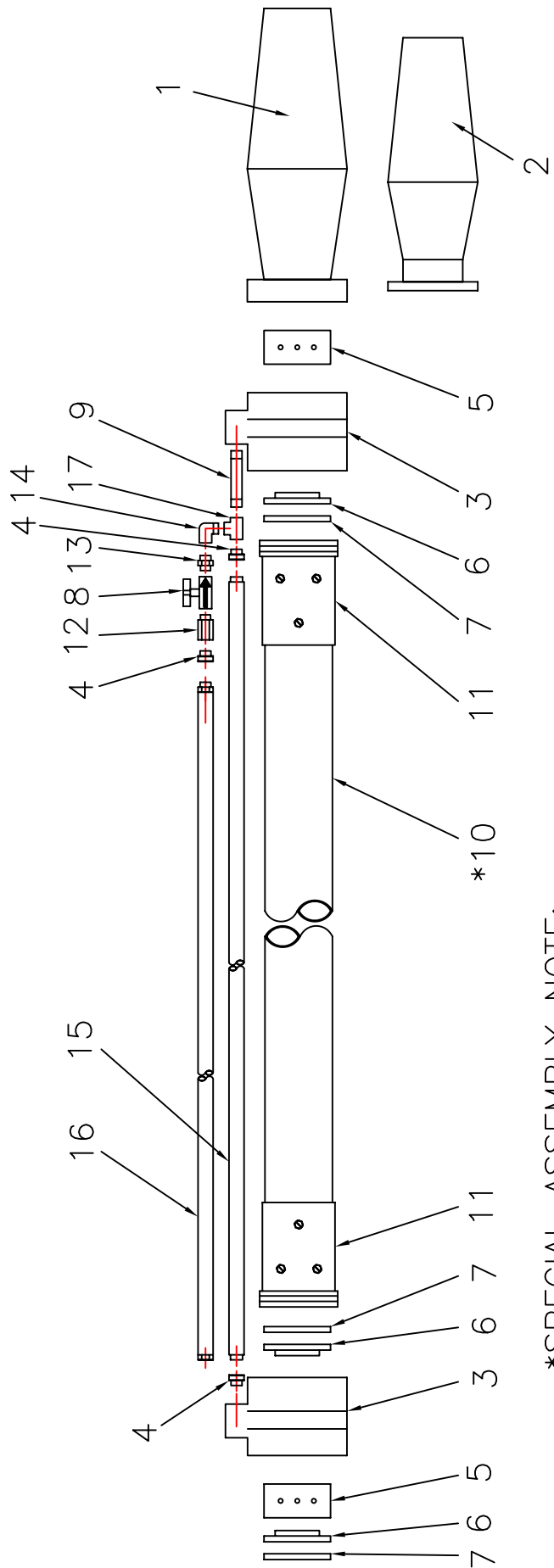

*SPECIAL ASSEMBLY NOTE:

*MUST CUT TO FIT AT ASSY IN RELATION TO ITEM #15 HOSE ASSY

BILL OF MATERIALS	
# 1-PN 12032 BARREL-2" NOZZLE (QTY-1)	#11-PN 11046 END-HOSE,MALE-CRSE 2"(QTY-2)
# 2-PN 12044 LINER-2" NOZZLE (QTY-1)	#12-PN 74675 REDUCER-1/2 NPTF X 3/8 NPTM (QTY-1)
# 3-PN 12056 BODY-NOZZLE 2" CRSE (QTY-2)	#13-PN 74890 ADAPTOR-1/2 NPTM X 3/8 NPTM (QTY-1)
# 4-PN 12061 ADAPTER-1/2" MALE NPT TO 3/4"FM (QTY-3)	#14-PN 10204 STREET ELBOW 1/2" 90(QTY-1)
# 5-PN 12066 RING-2" WATER (QTY-2)	#15-PN 12039 HOSE ASSY-(WATER) 4.5FT (QTY-1)
# 6-PN 12074 WASHER-BACKUP 2" CRSE (QTY-3)	#16-PN 12048 WATER HOSE ASSY-1 1/2" (QTY-1)
# 7-PN 12083 WASHER-RETAINER 2" CRSE ALUM (QTY-3)	#17-PN 10204 TEE 1/2"(QTY-1)
# 8-PN 11029 NEEDLE VALVE-3/8" (QTY-1)	
# 9-PN 10298 PIPE NIPPLE-1/2" X 3" (QTY-1)	
#10-PN 40449 HOSE, 2 IN GUNCRETE CONDUCT.(QTY-5.5FT)	

REED	CONCRETE PLACING EQUIPMENT	BY	DATE	TITLE	PART NUMBER	REV
	CHINO, CA 91710	EYBARRA	8/25/06	HYDRO NOZZLE ASSY-2"x5.5FT-(DBL WATER RING)	12092	

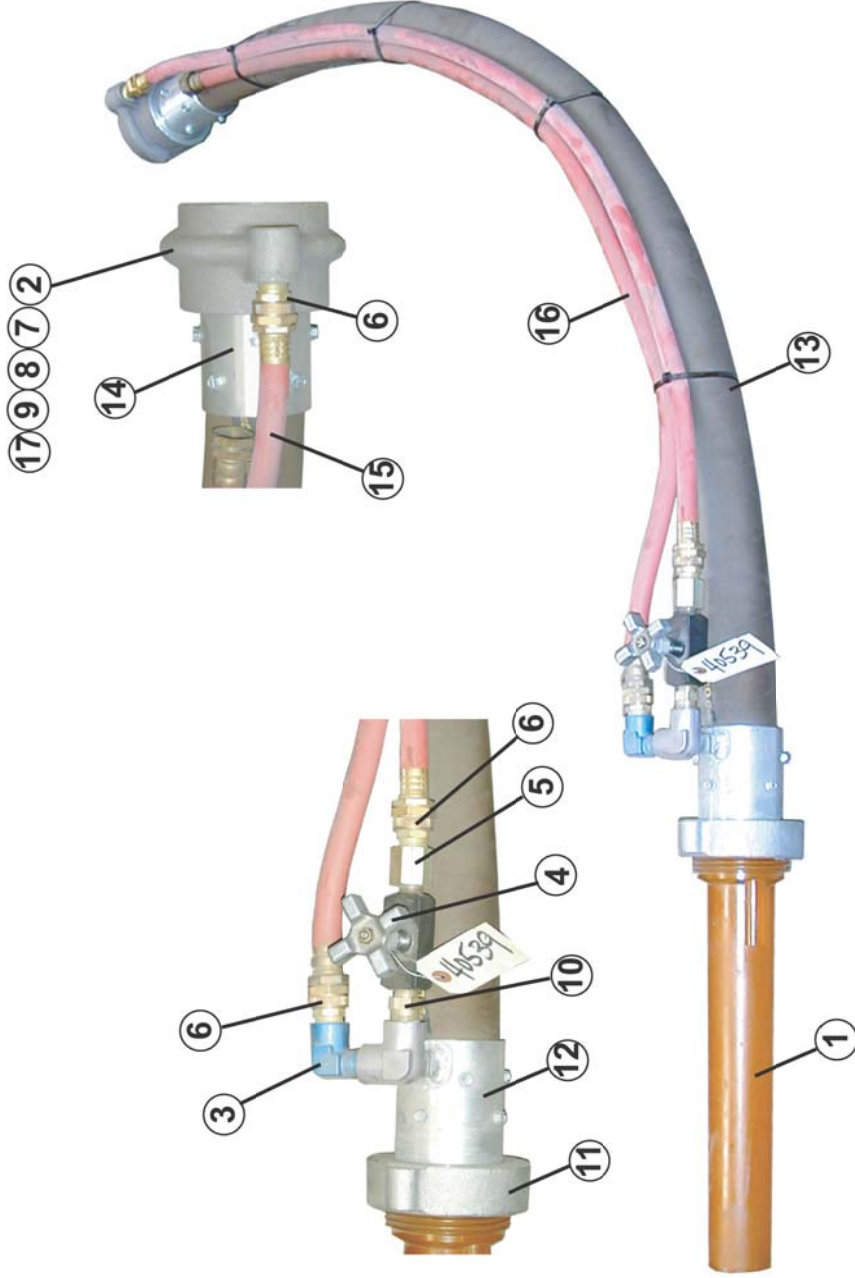

BILL of MATERIALS

- | | |
|---|--|
| # 1-PN 12004 TIP-2" (QTY-1) | # 9-PN 12083 WASHER-RETAINER 2 CRSE" (QTY-1) |
| # 2-PN 12056 BODY-NOZZLE 2" CRSE (QTY-1) | # 10-PN 74890 ADAPTER-1/2" x 3/8" (QTY-1) |
| # 3-PN 11992 ST. ELBOW 90 ALUM-1/2" (QTY-1) | # 11-PN 12091 NUT-D.B. RETAINER (QTY-1) |
| # 4-PN 11029 VALVE NEEDLE-3/8" (QTY-1) | # 12-PN 11995 HOSE END WELD-2" HYD NOZZLE (QTY-1) |
| # 5-PN 74675 REDUCER-1/2" TO 3/8" (QTY-1) | # 13-PN 40449 HOSE, 2" GUNCRETE CONDUCTIVE (QTY-5.5FT) |
| # 6-PN 12061 ADAPTER-1/2" TO 3/4" (QTY-3) | # 14-PN 11046 END-HOSE, MALE-CRSE 2" (QTY-1) |
| # 7-PN 12066 WATER RING-2" (QTY-1) | # 15-PN 12039 HOSE ASSY-(WATER) 4.5FT (QTY-1) |
| # 8-PN 12074 WASHER-BACKUP 2" CRSE (QTY-2) | # 16-PN 12048 WATER HOSE ASSY-1/2" (QTY-1) |
| | # 17-PN 74679 PLUG-1/4NPT SOCKET HEAD (QTY-2) |

REED CONCRETE PLACING EQUIPMENT
CHINO, CA 91710

TITLE: HYDRO NOZZLE ASSY-2 INCH FRONT VALVE
DRAWN BY: EYBARRA 10/09/2008

PART NUMBER
40539
SHT 1 OF 1

REV











GUNITE TOOLS AND SUPPLIES

CATEGORY	PART#	DESCRIPTION
CATEGORY	PART#	DESCRIPTION
SPIROLET NOZZLE	40821	2" NOZZLE TIP
 (OTHER SIZES AND ASSEMBLIES AVAILABLE UPON REQUEST)		
CATEGORY	PART#	DESCRIPTION
AIR HOSE	40591	2" X 50' COUPLED WITH DIXON BOSS FITTINGS – 150 PSI
	40593	1½" X 50' COUPLED WITH DIXON BOSS FITTINGS – 150 PSI
CATEGORY	PART#	DESCRIPTION
WATER/AIR HOSE	40590	¾" X 50' COUPLED WITH BRASS WATER FITTINGS – 150 PSI
	40589	¾" WATER COUPLINGS (LONG STEM)
CATEGORY	PART#	DESCRIPTION
SHOOTING WIRE	40600	.0348 SHOOTING WIRE (SOLD BY THE POUND) (AVERAGE WEIGHT PER ROLL – 46-48 LBS)
	40601	16½ GAUGE TIE WIRE (3.5 LBS ROLL)



GUNITE TOOLS AND SUPPLIES

CATEGORY	PART#	DESCRIPTION
GUNITE TOOLS	40615	24" GUNITE CUTTING ROD
	40620	36" GUNITE CUTTING ROD
	40625	48" GUNITE CUTTING ROD
	40635	24" STRAIGHT FRESNO – SQUARE ENDS
	40640	24" STRAIGHT FRESNO – ROUND ENDS
	40645	24" CURVED FRESNO – STRAIGHT ENDS
	40650	24" CURVED FRESNO – ROUND ENDS
	40655	30" STRAIGHT FRESNO – STRAIGHT ENDS
	40660	30" STRAIGHT FRESNO – ROUND ENDS
	40665	30" CURVED FRESNO – STRAIGHT ENDS
	40670	30" CURVED FRESNO – ROUND ENDS
	40675	6' WOOD FRESNO HANDLE
	40680	12" X 5" METAL FINISHING TROWEL
	40685	12" X 4" METAL FINISHING TROWEL
	40690	5" X 2" MARGIN TROWEL
	40695	12" X 4" WOOD FLOAT
	40700	14" X 4" WOOD FLOAT
	40705	16" X 3½" WOOD FLOAT

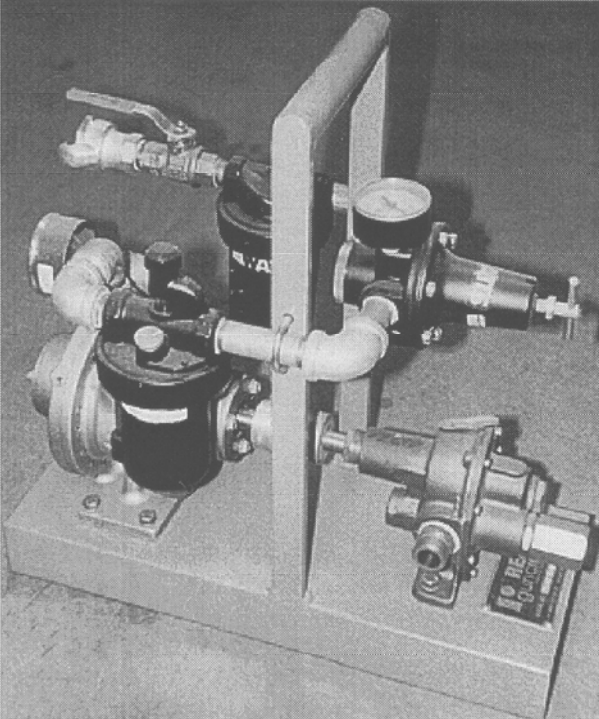
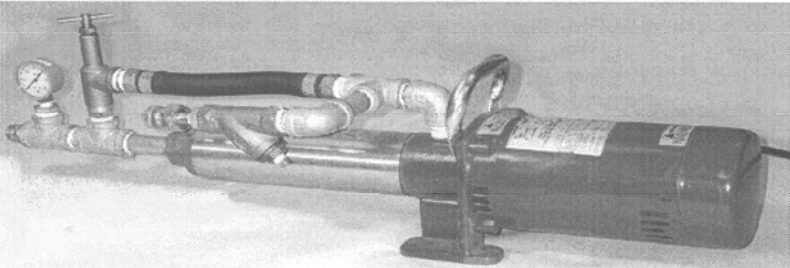

BOOSTER PUMPS

CATEGORY	PART#	DESCRIPTION
<p>AIR DRIVEN</p>  A black and white photograph of an air-driven booster pump assembly. It features a central vertical metal frame with a pump head mounted on the left side. Various pipes, valves, and a pressure gauge are connected to the assembly. The entire unit is mounted on a base plate.	4025	ROTARY GEAR, POSITIVE DISPLACEMENT PUMP, MAXIMUM DISCHARGE PRESSURE: 120 PSI (8.3 BAR), MAXIMUM SUCTION LIFT: 20 FEET (6M), ADJUSTABLE DISCHARGE PRESSURE RELIEF, PIPE SIZE: 3/4" (19mm) USED PRIMARILY IN GUNNING APPLICATIONS TO PROVIDE STABLE WATER PRESSURE AT NOZZLE.
<p>ELECTRIC DRIVEN</p>  A black and white photograph of an electric-driven booster pump assembly. It consists of a horizontal metal pipe with a pump head at one end and a pressure gauge. A black electric motor is connected to the pump head. The assembly is mounted on a small base.		MODEL BP250, PRESSURE TO 250 PSI (17.5 BAR), CAPACITIES TO 8 GPM (30.3 LPM), POWER SOURCE: ELECTRIC STANDARD, 115 OR 230 VOLT/60Hz, 1 PHASE, BY-PASS PRESSURE RELIEF VALVE ASSEMBLY, PIPE SIZE: 3/4" NPT



SAFETY DECALS

CATEGORY	PART#	QTY	DESCRIPTION
	10838	2	WARNING – SAFETY GLASSES
	10833	2	REED GUNCRETE
	10839	1	WARNING WEAR PAD
	10840	1	WARNING – INSIDE HOPPER
	10842	2	CAUTION – DO NOT LIFT HANDLES
	75005	2	NO HANDS SYMBOLS





RECOMMENDED SPARE PARTS - LOVA/LOHE

PART#	DESCRIPTION	QTY
10796	12 PKT W/DIVIDERS WEAR PLATE	2
10797	12 PKT W/DIVIDERS FEED BOWL	1
10336	WEAR PAD	60
10798	12 PKT DIVIDERLESS WEAR PLATE	2
10799	12 PKT DIVIDERLESS FEED BOWL	1
10336	WEAR PAD	60
10802	15 PKT LA WEAR PLATE	2
10803	15 PKT LA FEED BOWL	1
10336	WEAR PAD	60
10800	15 PKT STANDARD WEAR PLATE	2
10801	15 PKT STANDARD FEED BOWL	1
10338	WEAR PAD	60
10805	20 PKT WEAR PLATE	2
10806	20 PKT FEED BOWL	1
10338	WEAR PAD	60
10807	21 PKT WEAR PLATE	2
10808	21 PKT FEED BOWL	1
10339	WEAR PAD	60
10809	30 PKT FEED BOWL	1
10339	WEAR PAD	60
10042	1 1/2" L.T. GOOSENECK	1
13312	1 1/2" GOOSENECK LINER	5
10043	1 1/4" SOLID GOOSENECK	1
10044	1 1/2" SOLID GOOSENECK	1
10045	2" SOLID GOOSENECK	1
10046	2" L.T. GOOSENECK	1
10958	2" GOOSENECK LINER	5
10605	8AM AIR MOTOR REPAIR KIT	1
10606	16AM AIR MOTOR REPAIR KIT	1







RECOMMENDED SPARE PARTS - LOVA/LOHE

PART#	DESCRIPTION	QTY
10825	RISER PLATE - MEDIUM	2
10826	RISER PLATE - THICK	2
10827	RISER PLATE - THIN	2
10728	SPINDLE STUD	6
10005	FELT SEAL	5
10013	ROCK SHEAR - WIDE	1
10014	ROCK SHEAR - NARROW	1
	<u>ADDITIONAL PARTS FOR LOHE</u>	
10618	VARIABLE SPEED BELT (NORDGEAR MOTOR ASSEMBLY)	1
10102	VARIABLE SPEED BELT (BALDOR MOTOR)	1
	NOTE: WEAR PATE, FEED BOWL AND GOOSENECK WILL BE DETERMINED BY THE MACHNE SYSTEM SETUP.	

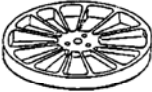

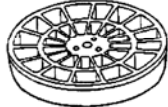
RECOMMENDED SPARE PARTS LOVA/LOHE SERIES IV

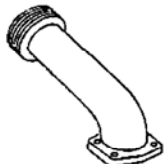
PART#	DESCRIPTION		QTY
10796	12 PKT W/DIVIDERS WEAR PLATE		2
10797	12 PKT W/DIVIDERS FEED BOWL		1
10783	12 PKT ROTARY FEED WHEEL		1
10336	WEAR PAD		60
10798	12 PKT DIVIDERLESS WEAR PLATE		2
10799	12 PKT DIVIDERLESS FEED BOWL		1
10336	WEAR PAD		60
10802	15 PKT LA WEAR PLATE		2
10803	15 PKT LA FEED BOWL		1
10780	15 PKT LA ROTARY FEED WHEEL		1
10336	WEAR PAD		60
10800	15 PKT STANDARD WEAR PLATE		2
10801	15 PKT STANDARD FEED BOWL		1
10781	15 PKT STANDARD ROTARY FEED WHEEL		1
10338	WEAR PAD		60
10805	20 PKT WEAR PLATE		2
10806	20 PKT FEED BOWL		1
10779	20 PKT ROTARY FEED WHEEL		1
10338	WEAR PAD		60
10807	21 PKT WEAR PLATE		2
10808	21 PKT FEED BOWL		1
10778	21 PKT ROTARY FEED WHEEL		1
10339	WEAR PAD		60
10809	30 PKT FEED BOWL		1
10339	WEAR PAD		60
10042	1 1/2" L.T. GOOSENECK		1
13312	1 1/2" GOOSENECK LINER		5
10043	1 1/4" SOLID GOOSENECK		1
10044	1 1/2" SOLID GOOSENECK		1
10045	2" SOLID GOOSENECK		1



RECOMMENDED SPARE PARTS
LOVA/LOHE SERIES IV

PART#	DESCRIPTION	QTY
10046	2" L.T. GOOSENECK	1
10958	2" GOOSENECK LINER	5
10605	8AM AIR MOTOR REPAIR KIT	1
10606	16AM AIR MOTOR REPAIR KIT	1
10825	RISER PLATE - MEDIUM	2
10826	RISER PLATE - THICK	2
10827	RISER PLATE - THIN	2
10728	SPINDLE STUD	6
10005	FELT SEAL	5
10013	ROCK SHEAR - WIDE	1
10014	ROCK SHEAR - NARROW	1
<u>ADDITIONAL PARTS FOR LOHE</u>		
10618	VARIABLE SPEED BELT (NORDGEAR MOTOR ASSEMBLY)	1
10102	VARIABLE SPEED BELT (BALDOR MOTOR)	1
<p>NOTE: WEAR PATE, FEED BOWL AND GOOSENECK WILL BE DETERMINED BY THE MACHNE SYSTEM SETUP.</p>		



RECOMMENDED SPARE PARTS - SOVA/SOVE

PART#	DESCRIPTION	QTY
20089	16 POCKET FEED BOWL	1
20189	18 POCKET FEED BOWL	1
10042	1 1/2" L.T. GOOSENECK	1
13312	1 1/2" GOOSENECK LINER	5
10044	1 1/2" SOLID GOOSENECK	1
10043	1 1/4" SOLID GOOSENECK	1
20090	WEAR PAD	50
20172	RISER PLATE - THIN	2
20173	RISER PLATE - MEDIUM	2
20174	RISER PLATE - THICK	2
20388	ROCK SHEAR	1
20158	FELT SEAL	5
10605	8AM AIR MOTOR REPAIR KIT	1
10618	VARIABLE SPEED BELT (ELECTRIC DRIVE ONLY)	1
	NOTE: FEED BOWL AND GOOSENECK WILL BE DETERMINED BY THE MACHNE SYSTEM SETUP.	



RECOMMENDED SPARE PARTS - 209A/209E

PART#	DESCRIPTION	QTY
20089	16 POCKET FEED BOWL	1
20189	18 POCKET FEED BOWL	1
10042	1 1/2" L.T. GOOSENECK	1
13312	1 1/2" GOOSENECK LINER	5
10044	1 1/2" SOLID GOOSENECK	1
10043	1 1/4" SOLID GOOSENECK	1
20090	WEAR PAD	50
20172	RISER PLATE - THIN	2
20173	RISER PLATE - MEDIUM	2
20174	RISER PLATE - THICK	2
20388	ROCK SHEAR	1
20158	FELT SEAL	5
10965	DUST BAG	1
10605	8AM AIR MOTOR REPAIR KIT	1
10618	VARIABLE SPEED BELT (ELECTRIC DRIVE ONLY)	1

NOTE: WEAR PATE, FEED BOWL AND GOOSENECK WILL BE DETERMINED BY THE MACHNE SYSTEM SETUP.



RECOMMENDED SPARE PARTS - 215A/215E

PART#	DESCRIPTION	QTY
10780	15 PKT LA ROTARY FEED WHEEL	1
10333	WEAR PAD	60
10781	15 PKT STANDARD ROTARY FEED WHEEL	1
10334	WEAR PAD	60
10778	20 PKT ROTARY FEED WHEEL	1
10334	WEAR PAD	60
10783	12 PKT ROTARY FEED WHEEL	1
10333	WEAR PAD	60
10042	1 1/2" L.T. GOOSENECK	1
13312	1 1/2" GOOSENECK LINER	5
10043	1 1/4" SOLID GOOSENECK	1
10044	1 1/2" SOLID GOOSENECK	1
10045	2" SOLID GOOSENECK	1
10046	2" L.T. GOOSENECK	1
10958	2" GOOSENECK LINER	5
10323	DUST BAG	1
10325	DUST BAG CLAMP	1
10825	RISER PLATE - MEDIUM	2
10826	RISER PLATE - THICK	2
10827	RISER PLATE - THIN	2
10728	SPINDLE STUD	6
13011	FELT SEAL	5
10606	16AM AIR MOTOR REPAIR KIT	1
13223	ROCK SHEAR - WIDE	1
13224	ROCK SHEAR - NARROW	1
10618	VARIABLE SPEED BELT (ELECTRIC DRIVE ONLY)	1

**NOTE: WEAR PATE, FEED BOWL AND GOOSENECK WILL BE
DETERMINED BY THE MACHNE SYSTEM SETUP.**



LOVA 8 TO LOVA 16 CHANGEOVER

PART#	DESCRIPTION	QTY
10603	16AM AIR MOTOR	1
10035	16AM ADAPTER PLATE	1
10036	16AM GASKET	1
10345	MUFFLER WELDMENT	1
10304	1 1/4" X 90 DEGREE ELBOW	1
10265	1 1/4" NIPPLE	1
10344	LOCKWASHER	1
10088	16AM AIR INLET ASSEMBLY	1
NPN	1 X 3/8" DOWEL PIN	2
NPN	1 X 1/16" HEX SCREW	4